

SUBMIT COMPLETED ORIGINAL APPLICATION, TAX STATEMENT AND FEE TO:  
 Bayfield County Zoning Department  
 P.O. Box 58  
 Washburn, WI 54891  
 (715) 373-6138

APPLICATION FOR PERMIT  
 BAYFIELD COUNTY, WISCONSIN

RECEIVED

JUN 26 2009

Application No.: 09-0275  
 Date: \_\_\_\_\_  
 Zoning District: RRB  
 Amount Paid: \$75  
6/26/09 *mg*

INSTRUCTIONS: No permits will be issued until all fees are paid. Checks are made payable to: Bayfield County Zoning Department. DO NOT START CONSTRUCTION UNTIL ALL PERMITS HAVE BEEN ISSUED TO APPLICANT. Changes in plans must be approved by the Zoning Department.

LAND USE  SANITARY  PRIVY  CONDITIONAL USE  SPECIAL USE  B.O.A.  OTHER \_\_\_\_\_

Use Tax Statement for Legal Description

Legal Description: 1/4 of \_\_\_\_\_ 1/4 of Section 20 Township 43 North, Range 7 West, Town of Cable  
 Gov't Lot S1/2 Lot 4 Block \_\_\_\_\_ Subdivision \_\_\_\_\_  
 Volume 879 Page 634 of Deeds Parcel I.D. 04-012-2-43-07-20-1 03-000-40000

Property Owner Michael Cheste Contractor HOMEOOWNER (Phone) \_\_\_\_\_  
 Address of Property 14795 McNaught Rd Plumber \_\_\_\_\_  
Cable, WI 54821

Telephone (773) 991-5944 (Home) \_\_\_\_\_ (Work) \_\_\_\_\_  
 Authorized Agent \_\_\_\_\_ (Phone) \_\_\_\_\_

Is your structure in a Shoreland Zone? Yes  No  If yes, \_\_\_\_\_

Structure: New  Addition  Existing   
 Fair Market Value \$10,000 Square Footage 840 sq ft  
 USE: \_\_\_\_\_

- \* Residence or Principal Structure (# of bedrooms) \_\_\_\_\_
- Residence sq. ft. \_\_\_\_\_
- \* Residence w/deck-porch (# of bedrooms) \_\_\_\_\_
- Residence sq. ft. \_\_\_\_\_ Porch sq. ft. \_\_\_\_\_
- Deck sq. ft. \_\_\_\_\_ Deck(2) sq. ft. \_\_\_\_\_
- \* Residence w/attached garage (# of bedrooms) \_\_\_\_\_
- Residence sq. ft. \_\_\_\_\_ Garage sq. ft. \_\_\_\_\_
- Residential Addition / Alteration (explain) 940 sq ft concrete
- Residential-Accessory-Building (explain) Deck & Screened Porch
- Residential-Accessory-Building-Addition (explain) Rebar for slab
- Residential-Other (explain) Deck w/ concrete slab

FAILURE TO OBTAIN A PERMIT OF STARTING CONSTRUCTION WITHOUT A PERMIT WILL RESULT IN PENALTIES. I (we) declare that this application (including any accompanying information) has been examined by me (us) and to the best of my (our) knowledge and belief it is true, correct and complete. I (we) acknowledge that I (we) am (are) responsible for the detail and accuracy of all information I (we) am (are) providing and that it will be relied upon by Bayfield County in determining whether to issue a permit. I (we) further accept liability which may be a result of Bayfield County relying on this information I (we) am (are) providing in or with this application. I (we) consent to county officials charged with administering county ordinances to have access to the above described property at any reasonable time for the purpose of inspection.

Owner or Authorized Agent (Signature) Michael Cheste Date 6/25/09  
 Address to send permit: 2747 W SAYRE ST CHICAGO IL 60707 ATTACH \_\_\_\_\_  
 \* See Notice on Back Copy of Tax Statement or \_\_\_\_\_ Attach a Copy of Recorded Deed

APPLICANT — PLEASE COMPLETE REVERSE SIDE

Permit Issued: State Sanitary Number \_\_\_\_\_ Date \_\_\_\_\_  
 Date 7-13-09 Permit Number 09-0275 Permit Denied (Date) \_\_\_\_\_  
 Reason for Denial: \_\_\_\_\_  
 Inspection Record: Meets all setbacks property line's per owner's representations  
 By M. Furtak Date of Inspection 7-9-09  
 Mitigation Plan Required: Yes  No  Variance (B.O.A.) # \_\_\_\_\_  
 Condition: \_\_\_\_\_

Signed Michael Furtak 7-10-09  
 Inspector \_\_\_\_\_  
 Date of Approval \_\_\_\_\_  
 Rec'd for Issuance \_\_\_\_\_

JUL 13 2009

Secretarial Staff

Lot Line

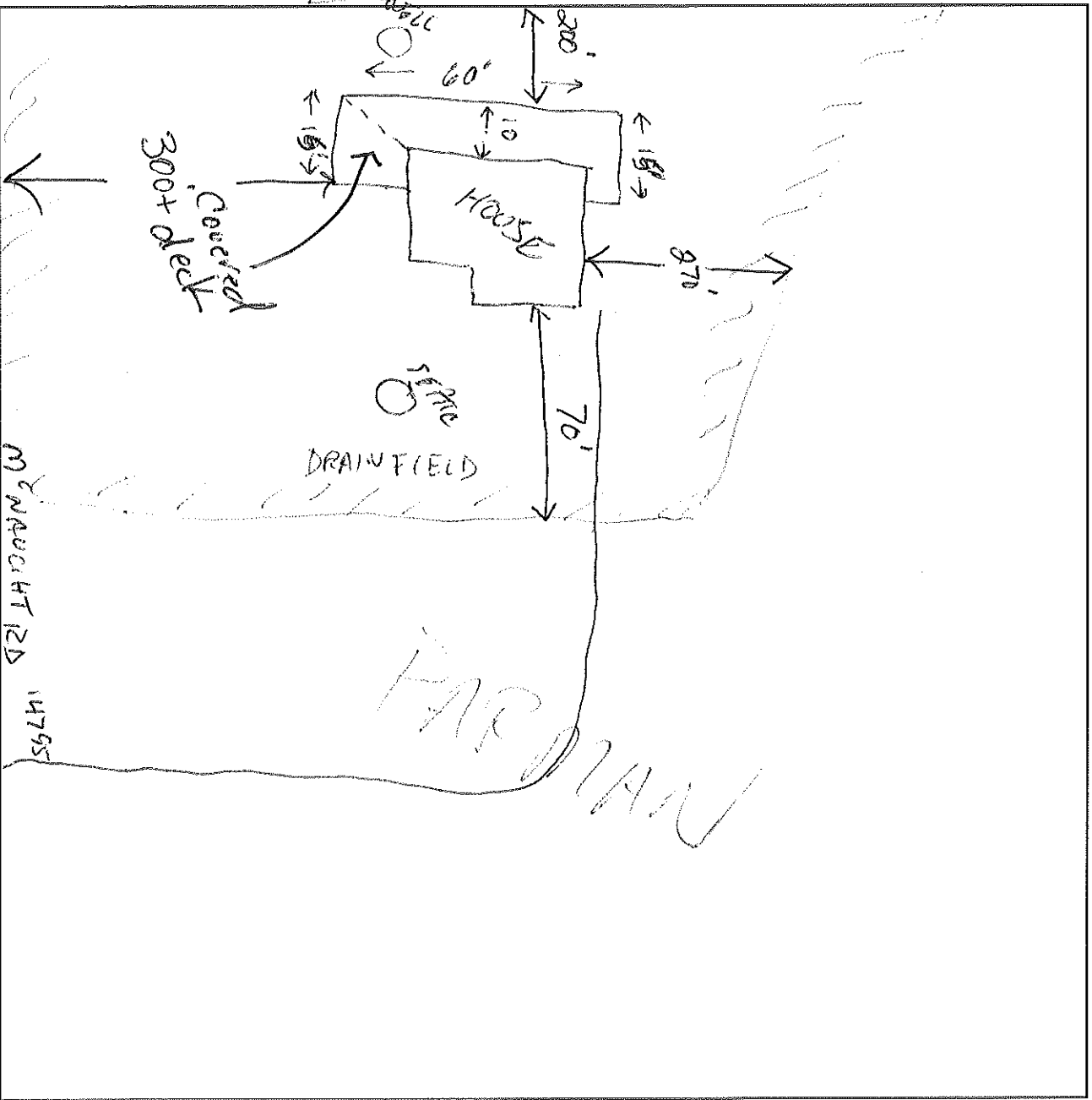

Name of Frontage Road (McNaught Rd)

1. Name the frontage road and use as a guideline, fill in the lot dimensions and indicate North (N).
2. Show the location, size and dimensions of the structure.
3. Show the location, size and dimensions of attached deck(s), porch(s) or garage.
4. Show the location of the well, holding tank, septic tank and drain field.
5. Show the location of any lake, river, stream or pond if applicable.
6. Show the location of other existing structures.
7. Show the location of any wetlands or slopes over 20 percent.
8. Show dimensions in feet on the following:
  - a. Building to all lot lines
  - b. Building to centerline of road
  - c. Building to lake, river, stream or pond
  - d. Holding tank to closest lot line
  - e. Holding tank to building
  - f. Holding tank to well
  - g. Holding tank to lake, river, stream or pond
  - h. Privy to closest lot line
  - i. Privy to building
  - j. Privy to lake, river, stream or pond
  - k. Septic Tank and Drain field to closest lot line
  - l. Septic Tank and Drain field to building
  - m. Septic Tank and Drain field to well
  - n. Septic Tank, and Drain field to lake, river, stream or pond.
  - o. Well to building

**IMPORTANT**  
DETAILED PLOT PLAN  
IS NECESSARY. FOLLOW  
STEPS 1-8 (a-o) COMPLETELY.

\*NOTICE: All Land Use Permits Expire One (1) Year From The Date Issued.

For The Construction Of New One & Two Family Dwellings: ALL Municipalities Are Required To Enforce The Uniform Dwelling Code.  
You Must Contact Your Town Chairman / Clerk For More Information.

The local town, village, city, state or federal agencies may also require permits.

Stake or mark proposed location(s) of new building, holding tank, septic, drain field, privy, and well. Inspector will not make an inspection until location(s) are staked or marked.