

SUBMIT COMPLETED ORIGINAL APPLICATION, TAX STATEMENT AND FEE TO:
 Bayfield County Zoning Department
 P.O. Box 58
 Washburn, WI 54891
 (715) 373-6138

APPLICATION FOR PERMIT
 BAYFIELD COUNTY, WISCONSIN

RECEIVED

JUN 04 2010

Application No. 10-0177
 Date: _____
 Zoning District F-1
 Amount Paid: 1256/2/10 mg

INSTRUCTIONS: No permits will be issued until all fees are paid. Checks are made payable to: Bayfield County Zoning Department. DO NOT START CONSTRUCTION UNTIL ALL PERMITS HAVE BEEN ISSUED TO APPLICANT. Changes in plans must be approved by the Zoning Department.

LAND USE SANITARY PRIVY CONDITIONAL USE SPECIAL USE B.O.A. OTHER _____

Use Tax Statement for Legal Description

Legal Description SW 1/4 of SW 1/4 of Section 34 Township 45 North, Range 9 West, Town of Barnes

Gov't Lot _____ Lot _____ Block _____ Subdivision _____ CSM # 28

Volume 1004 Page 981 of Deeds Parcel I.D. 04-004-2-45-09-24-303-000-10000

Property Owner John J TRAYNOR Contractor _____ (Phone) _____

Address of Property 4080 E Robinson Lake Road Number _____

Barnes WI Authorized Agent _____ (Phone) _____

Telephone 715-770-5580 (Home) 715-425-8588 (Work)

Is your structure in a Shoreland Zone? Yes No if yes.

Structure: New Addition Existing _____

Fair Market Value 10,500 Square Footage 900

USE: Residence of Principal Structure (# of bedrooms) garage

Residence sq. ft. _____

Residence w/deck-porch (# of bedrooms) _____

Residence sq. ft. _____ Porch sq. ft. _____

Deck sq. ft. _____ Deck(2) sq. ft. _____

Residence w/attached garage (# of bedrooms) _____

Residence sq. ft. _____ Garage sq. ft. _____

Residential Addition / Alteration (explain) _____

Residential Accessory Building (explain) _____

Residential Accessory Building Addition (explain) _____

Residential Other (explain) _____

Commercial Principal Building _____

Commercial Principal Building Addition (explain) _____

Commercial Accessory Building (explain) _____

Commercial Accessory Building Addition (explain) _____

Commercial Other (explain) _____

Special/Conditional Use (explain) _____

External Improvements to Principal Building (explain) _____

External Improvements to Accessory Building (explain) _____

FAILURE TO OBTAIN A PERMIT OR STARTING CONSTRUCTION WITHOUT A PERMIT WILL RESULT IN PENALTIES

I (we) declare that this application (including any accompanying information) has been examined by me (us) and to the best of my (our) knowledge and belief it is true, correct and complete. I (we) acknowledge that I (we) am (are) responsible for the detail and accuracy of all information I (we) am (are) providing and that it will be relied upon by Bayfield County in determining whether to issue a permit. I (we) further accept liability which may be a result of Bayfield County relying on this information I (we) am (are) providing in or with this application. I (we) consent to county officials charged with administering county ordinances to have access to the above described property at any reasonable time for the purpose of inspection.

Owner or Authorized Agent (Signature) John J Traynor Date 6/4/2010

Address to send permit 1315 Orange St. River Falls, WI 54022

* See Notice on Back

APPLICANT — PLEASE COMPLETE REVERSE SIDE

Copy of Tax Statement or ATTACH

(If you recently purchased the property Attach a Copy of Recorded Deed)

Permit issued: _____ State Sanitary Number _____ Date _____

Date 6/9/10 Permit Number 10-0177 Permit Denied (Date) _____

Reason for Denial: _____

Inspection Record: Well stocked. Property lines per owner's representations. Meats all so shaded. By M. Furtak Date of Inspection 6-8-10

Mitigation Plan Required: Yes No Variance (B.O.A.) # _____

Condition: Not to be used for human habitation. No water under pressure may enter structure.

Signed Michael Furtak 6-9-10 Date of Approval

Inspector Michael Furtak Rec'd for Issuance

JUN 9 2010

Secretarial Staff

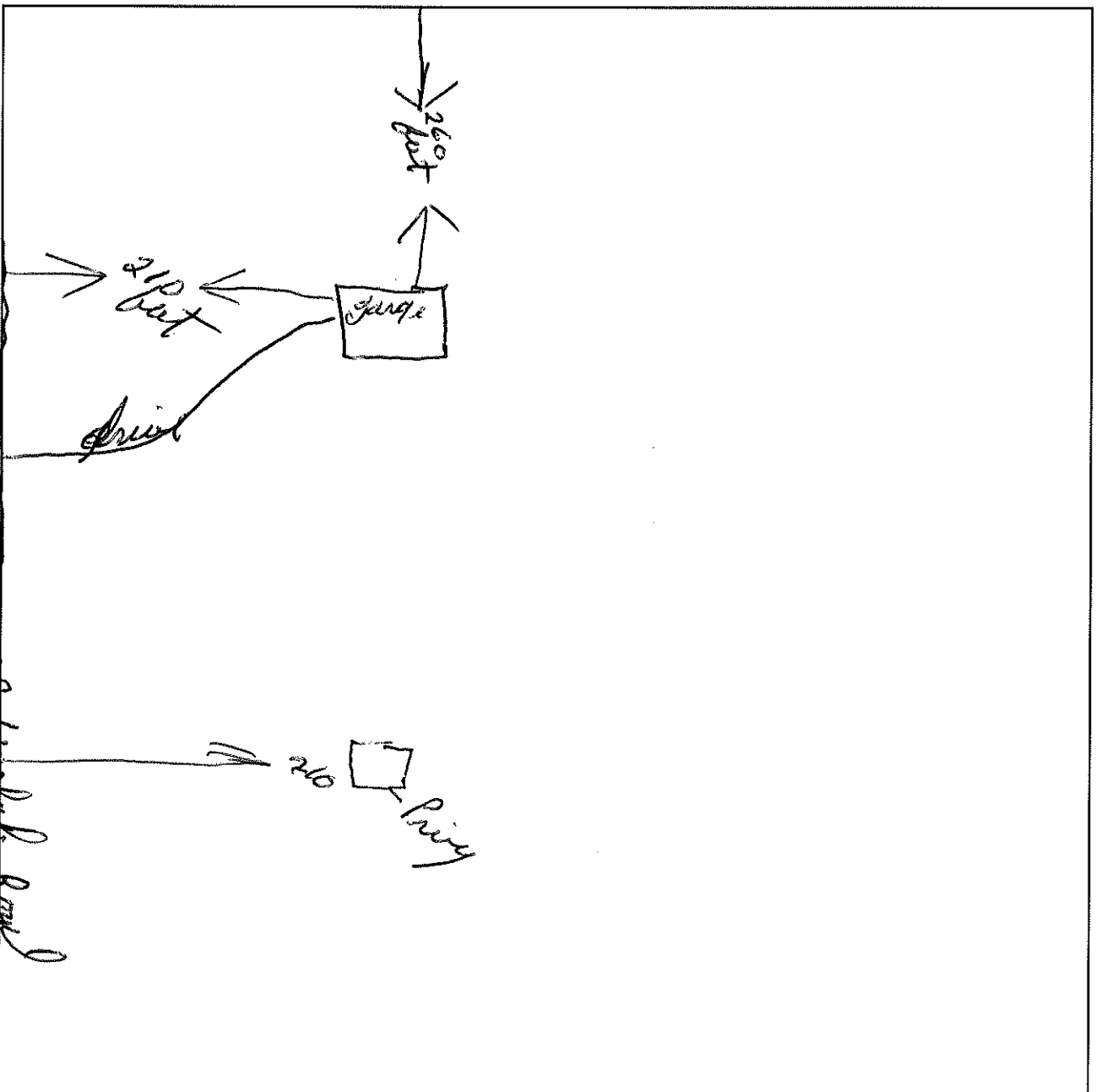

Name of Frontage Road (_____)

1. Name the frontage road and use as a guideline, fill in the lot dimensions and indicate North (N).
2. Show the location, size and dimensions of the structure.
3. Show the location, size and dimensions of attached deck(s), porch(s) or garage.
4. Show the location of the well, holding tank, septic tank and drain field.
5. Show the location of any lake, river, stream or pond if applicable.
6. Show the location of other existing structures.
7. Show the location of any wetlands or slopes over 20 percent.
8. Show dimensions in feet on the following:
 - a. Building to all lot lines
 - b. Building to centerline of road
 - c. Building to lake, river, stream or pond
 - d. Holding tank to closest lot line
 - e. Holding tank to building
 - f. Holding tank to well
 - g. Holding tank to lake, river, stream or pond
 - h. Privy to closest lot line
 - i. Privy to building
 - j. Privy to lake, river, stream or pond
 - k. Septic Tank and Drain field to closest lot line
 - l. Septic Tank and Drain field to building
 - m. Septic Tank and Drain field to well
 - n. Septic Tank, and Drain field to lake, river, stream or pond.
 - o. Well to building

IMPORTANT
 DETAILED PLOT PLAN
 IS NECESSARY. FOLLOW
 STEPS 1-8 (a-o) COMPLETELY.

*NOTICE: All Land Use Permits Expire One (1) Year From The Date Issued.

For The Construction Of New One & Two Family Dwellings: ALL Municipalities Are Required To Enforce The Uniform Dwelling Code. You Must Contact Your Town Chairman / Clerk For More Information.

The local town, village, city, state or federal agencies may also require permits.

Stake or mark proposed location(s) of new building, holding tank, septic, drain field, privy, and well. Inspector will not make an inspection until location(s) are staked or marked.