

SUBMIT: COMPLETED APPLICATION, TAX STATEMENT AND FEE TO:
 Bayfield County
 Planning and Zoning Depart.
 PO Box 58
 Washburn, WI 54891
 (715) 373-6138

APPLICATION FOR PERMIT
 BAYFIELD COUNTY, WISCONSIN

\$125



Permit #:	13-0384	ENTERED
Date:	10-30-13	
Amount Paid:	\$125	
Refund:	9-24-13	

INSTRUCTIONS: No permits will be issued until all fees are paid. Checks are made payable to: Bayfield County Zoning Department. DO NOT START CONSTRUCTION UNTIL ALL PERMITS HAVE BEEN ISSUED TO APPLICANT. HOW DO I FILL OUT THIS APPLICATION (visit our website www.bayfieldcounty.org/zoning.asp)

TYPE OF PERMIT REQUESTED: LAND USE SANITARY PRIVY CONDITIONAL USE SPECIAL USE B.O.A. OTHER

Owner's Name: Turn of Cable Mailing Address: _____ City/State/Zip: _____ Telephone: 715 798-4440

Address of Property: 12955 Cable Sunset Rd City/State/Zip: Cable, WI 54821 Cell Phone: _____

Contractor: Nonvoda (TRSD) Contractor Phone: _____ Plumber: _____ Plumber Phone: _____

Authorized Agent: (Person Signing Application on behalf of Owner(s)) Gun Folson Agent Phone: 798-3303 Agent Mailing Address (include City/State/Zip): PO Box 67, Cable, WI 54821 Written Authorization Attached Yes No

PROJECT LOCATION: NE 1/4, SE 1/4 Legal Description: (Use Tax Statement) 04-012-3-43-08-13-401-000-10000 P.L.N.: (23 digits) _____ Recorded Document: (i.e. Property Ownership) Volume 363 Page(s) 164

Section 13, Township 43 N, Range 8 W Town of: Cable Lot Size _____ Acreage 2829

Shoreland Non-Shoreland

Is Property/Land within 300 Feet of River, Stream (incl. intermittent) Creek or Landward side of Floodplain? If yes---continue If yes---continue

Is Property/Land within 1000 feet of Lake, Pond or Flowage If yes---continue

Distance Structure is from Shoreline: _____ feet Is Property in Floodplain Zone? Yes No

Distance Structure is from Shoreline: _____ feet Yes No

Are Wetlands Present? Yes No

Value at Time of Completion * Include donated time & material	Project (What are you applying for)	# of Stories and/or basement	Use	# of bedrooms	What Type of Sewer/Sanitary System is on the property?	Water
\$ 25,000	<input type="checkbox"/> New Construction <input checked="" type="checkbox"/> Addition/Alteration <input type="checkbox"/> Conversion <input type="checkbox"/> Relocate (existing bldg) <input type="checkbox"/> Run a Business on Property	<input type="checkbox"/> 1-Story <input checked="" type="checkbox"/> 1-Story + Loft <input type="checkbox"/> 2-Story <input type="checkbox"/> Basement	<input type="checkbox"/> Seasonal <input checked="" type="checkbox"/> Year Round <input type="checkbox"/> _____ <input type="checkbox"/> _____	<input type="checkbox"/> 1 <input checked="" type="checkbox"/> 2 <input type="checkbox"/> 3 <input type="checkbox"/> None	<input type="checkbox"/> Municipal/City <input type="checkbox"/> (New) Sanitary <input type="checkbox"/> Sanitary (Exists) Specify Type: _____ <input type="checkbox"/> Privy (Pit) or Vaulted (min 200 gallon) <input type="checkbox"/> Portable (w/service contract) <input checked="" type="checkbox"/> Compost Toilet <input type="checkbox"/> None	<input type="checkbox"/> City <input type="checkbox"/> Well

Existing Structure: (if permit being applied for is relevant to it) Length: _____ Width: _____ Height: _____

Proposed Construction: Length: _____ Width: _____ Height: _____

Proposed Use	Proposed Structure	Dimensions	Square Footage
<input checked="" type="checkbox"/>	Principal Structure (first structure on property)	(X)	
<input type="checkbox"/>	Residence (i.e. cabin, hunting shack, etc.)	(X)	
<input type="checkbox"/>	with Loft	(X)	
<input type="checkbox"/>	with a Porch	(X)	
<input type="checkbox"/>	with (2 nd) Deck	(X)	
<input checked="" type="checkbox"/>	with (2 nd) Deck with Attached Garage	(X)	
<input type="checkbox"/>	Bunkhouse w/ (<input type="checkbox"/> sanitary, or <input type="checkbox"/> sleeping quarters, or <input type="checkbox"/> cooking & food prep facilities)	(X)	
<input type="checkbox"/>	Mobile Home (manufactured date) _____	(X)	
<input type="checkbox"/>	Addition/Alteration (specify) _____	(X)	
<input type="checkbox"/>	Accessory Building (specify) _____	(X)	
<input type="checkbox"/>	Accessory Building Addition/Alteration (specify) _____	(X)	
<input type="checkbox"/>	Special Use: (explain) _____	(X)	
<input checked="" type="checkbox"/>	Conditional Use: (explain) <u>Increase Tower Height To 200'</u>	(X)	
<input type="checkbox"/>	Other: (explain) _____	(X)	

Secretarial Staff: _____

FAILURE TO OBTAIN A PERMIT OR STARTING CONSTRUCTION WITHOUT A PERMIT WILL RESULT IN PENALTIES

I (we) declare that this application (including any accompanying information) has been examined by me (us) and to the best of my (our) knowledge and belief it is true, correct and complete. I (we) acknowledge that I (we) am (are) responsible for the detail and accuracy of all information I (we) am (are) providing and that it will be relied upon by Bayfield County in determining whether to issue a permit. I (we) further accept liability which may be a result of Bayfield County relying on this information. I (we) am (are) providing in or with this application. I (we) consent to county officials charged with administering county ordinances to have access to the above described property at any reasonable time for the purpose of inspection.

Owner(s): _____ Date: _____

(if there are Multiple Owners listed on the Deed All Owners must sign or letter(s) of authorization must accompany this application)

Authorized Agent: see file Date: 8-29-13

(if you are signing on behalf of the owner(s) a letter of authorization must accompany this application)

Address to send permit: PO BOX 67 CABLE, WI 54821 Attach Copy of Tax Statement

Address to send permit: _____ If you recently purchased the property send your Recorded Deed

Draw or Sketch your Property (Regardless of what you are applying for)

- (1) Show Location of: **Proposed Construction**
 (2) Show / Indicate: North (N) on Plot Plan
 (3) Show Location of (*): (*) Driveway and (*) Frontage Road (Name Frontage Road)
 (4) Show: All Existing Structures on your Property
 (5) Show: (*) Well (W); (*) Septic Tank (ST); (*) Drain Field (DF); (*) Holding Tank (HT) and/or (*) Privy (P)
 (6) Show any (*): (*) Lake; (*) River; (*) Stream/Creek; or (*) Pond
 (7) Show any (*): (*) Wetlands; or (*) Slopes over 20%

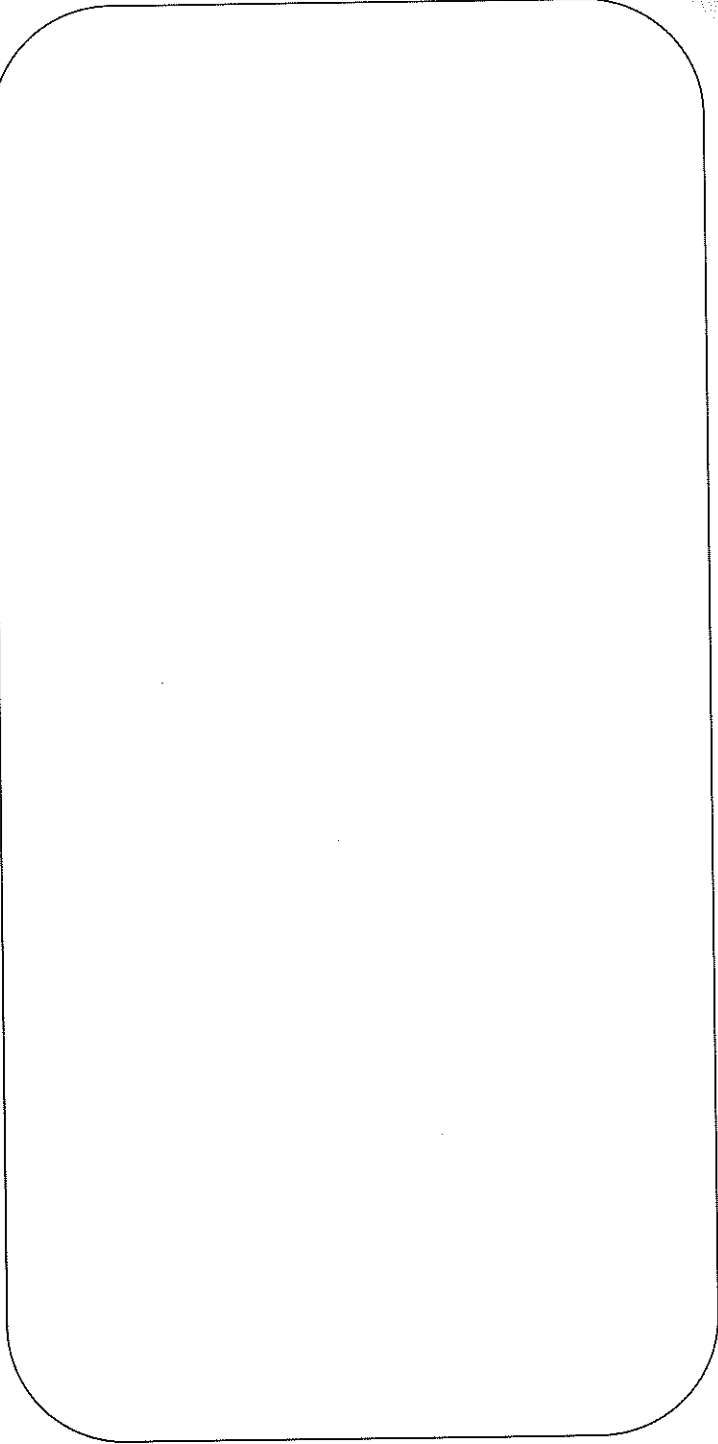

Please complete (1) - (7) above (prior to continuing)

Changes in plans must be approved by the Planning & Zoning Dept.

(8) Setbacks: (measured to the closest point)

Description	Measurement	Description	Measurement
Setback from the Centerline of Platted Road	Feet	Setback from the Lake (ordinary high-water mark)	Feet
Setback from the Established Right-of-Way	Feet	Setback from the River, Stream, Creek	Feet
Setback from the North Lot Line	Feet	Setback from the Bank or Bluff	Feet
Setback from the South Lot Line	Feet	Setback from Wetland	Feet
Setback from the West Lot Line	Feet	Setback from 20% Slope Area	Feet
Setback from the East Lot Line	Feet	Elevation of Floodplain	Feet
Setback to Septic Tank or Holding Tank	Feet	Setback to Well	Feet
Setback to Drain Field	Feet		
Setback to Privy (Portable, Composting)	Feet		

Prior to the placement or construction of a structure within ten (10) feet of the minimum required setback, the boundary line from which the setback must be measured must be visible from one previously surveyed corner to the owner's expense.
 Prior to the placement or construction of a structure within ten (10) feet of the minimum required setback, the boundary line from which the setback must be measured must be visible from other previously surveyed corner or marked by a licensed surveyor at the owner's expense.
 Prior to the placement or construction of a structure more than ten (10) feet but less than thirty (30) feet from the minimum required setback, the boundary line from which the setback must be measured must be visible from one previously surveyed corner to the other previously surveyed corner, or verifiable by the Department by use of a corrected compass from a known corner within 500 feet of the proposed site of the structure, or must be marked by a licensed surveyor at the owner's expense.

(9) Stake or Mark Proposed Location(s) of New Construction, Septic Tank (ST), Drain field (DF), Holding Tank (HT), Privy (P), and Well (W).

NOTICE: All Land Use Permits Expire One (1) Year from the Date of Issuance if Construction or Use has not begun.
 For The Construction Of New One & Two Family Dwelling: All Municipalities Are Required To Enforce The Uniform Dwelling Code.
 The local Town, Village, City, State or Federal agencies may also require permits.

Issuance Information (County Use Only)		Sanitary Number:	# of bedrooms:	Sanitary/Date:
Permit Denied (Date):	Reason for Denial:			
Permit #: 13-0389	Permit Date: 10-30-13			
<input type="checkbox"/> Is Parcel a Sub-Standard Lot <input type="checkbox"/> Is Parcel in Common Ownership <input type="checkbox"/> Is Structure Non-Conforming	<input type="checkbox"/> Yes (Deed of Record) <input checked="" type="checkbox"/> Yes (fused/contiguous lot(s)) <input type="checkbox"/> No	<input type="checkbox"/> Mitigation Required <input type="checkbox"/> Mitigation Attached	<input type="checkbox"/> Yes <input checked="" type="checkbox"/> No	<input type="checkbox"/> Affidavit Required <input type="checkbox"/> Affidavit Attached
<input type="checkbox"/> Granted by Variance (B.O.A.) <input checked="" type="checkbox"/> Yes <input type="checkbox"/> No	Case #:	<input type="checkbox"/> Previously Granted by Variance (B.O.A.) <input checked="" type="checkbox"/> Yes <input type="checkbox"/> No	Case #:	<input checked="" type="checkbox"/> Affidavit Required <input type="checkbox"/> Affidavit Attached
<input type="checkbox"/> Was Parcel Legally Created <input checked="" type="checkbox"/> Yes <input type="checkbox"/> No	<input type="checkbox"/> Was Proposed Building Site Delineated <input checked="" type="checkbox"/> Yes <input type="checkbox"/> No	<input type="checkbox"/> Were Property Lines Represented by Owner <input checked="" type="checkbox"/> Yes <input type="checkbox"/> No	<input checked="" type="checkbox"/> Zoning District <input type="checkbox"/> Lakes Classification	<input type="checkbox"/> Date of Re-Inspection:
Inspection Record:				
Date of Inspection: 10-10-13	Inspected by: My Fuchs			
Condition(s): Town, Committee or Board Conditions Attached? <input type="checkbox"/> Yes <input checked="" type="checkbox"/> No (If No they need to be attached.)				
Signature of Inspector: Michael Fuchs				Date of Approval: 10-24-13
Hold For Sanitary: <input type="checkbox"/>	Hold For TBA: <input type="checkbox"/>	Hold For Affidavit: <input type="checkbox"/>	Hold For Fees: <input type="checkbox"/>	<input type="checkbox"/>

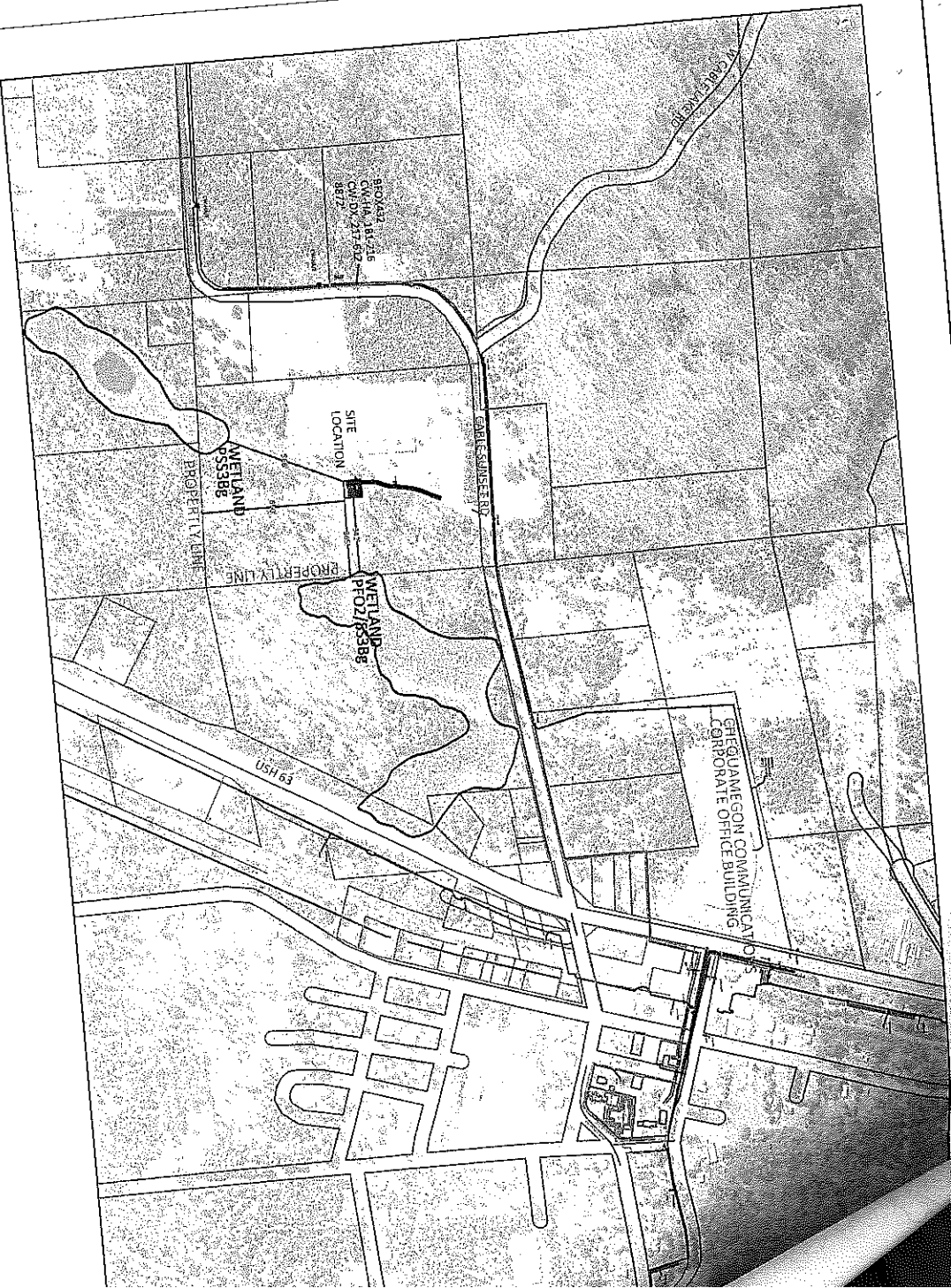

ORTHO OVERVIEW

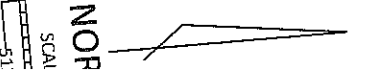

LOC
TOM
SHEE
DRAI

LOCATION	CABLE, WI	REVISIONS	DATE
TOWER SITE ID:	B19	PRELIMINARY PLANS	10/15/09
SHEET NUMBER	4		
DRAWN BY	GAF		

Chequ
Communications

V1033 P816