



SUBMIT COMPLETED ORIGINAL APPLICATION, TAX STATEMENT AND FEE TO:  
 Bayfield County Zoning Department  
 P.O. Box 58  
 Washburn, WI 54891  
 (715) 373-6138

APPLICATION FOR PERMIT  
 BAYFIELD COUNTY, WISCONSIN

RECEIVED

JUN 17 2010

Application No.: 10-0225  
 Date: \_\_\_\_\_  
 Zoning District F-1  
 Amount Paid: \$75.00 P.O.S  
G118/2010

INSTRUCTIONS: No permits will be issued until all fees are paid. Checks are made payable to: Bayfield County Zoning Department. DO NOT START CONSTRUCTION UNTIL ALL PERMITS HAVE BEEN ISSUED TO APPLICANT. Changes in plans must be approved by the Zoning Department.

LAND USE  SANITARY  PRIVY  CONDITIONAL USE  SPECIAL USE  B.O.A.  OTHER \_\_\_\_\_

Use Tax Statement for Legal Description

Legal Description SE 1/4 of SW 1/4 of Section 8 Township 49 North, Range 8 West, Town of Porturing  
 Gov't Lot \_\_\_\_\_ Lot \_\_\_\_\_ Block \_\_\_\_\_ Subdivision \_\_\_\_\_ CSM # \_\_\_\_\_ Acreage 40

Volume 904 Page 586 of Deeds Parcel I.D. 04-042-2-45-08-08-3 04-000-10000  
 Property Owner's Reedy Johnson Fred Johnson (Finger)  
Tina Helen, Becky Prusko (Benn)  
 Address of Property Port Wing, WI  
5330  
 Telephone 715-372-4497 (Home) 715-292-0226 (Work)

Is your structure in a Shoreland Zone? Yes  No  If yes,  
 Structure: New \_\_\_\_\_ Addition  Existing \_\_\_\_\_  
 Fair Market Value \$5,000.00 Square Footage 384  
 USE:  
 \* Residence or Principal Structure (# of bedrooms) \_\_\_\_\_  
 Residence sq. ft. \_\_\_\_\_  
 \* Residence w/deck-porch (# of bedrooms) \_\_\_\_\_  
 Residence sq. ft. \_\_\_\_\_ Porch sq. ft. \_\_\_\_\_  
 Deck sq. ft. \_\_\_\_\_ Deck(2) sq. ft. \_\_\_\_\_  
 \* Residence w/attached garage (# of bedrooms) \_\_\_\_\_  
 Residence sq. ft. \_\_\_\_\_ Garage sq. ft. \_\_\_\_\_

Residential Addition / Alteration (explain) Great Room  
 Residential Accessory Building (explain) \_\_\_\_\_  
 Residential Accessory Building Addition (explain) \_\_\_\_\_  
 Residential Other (explain) \_\_\_\_\_  
 \* Commercial Principal Building \_\_\_\_\_  
 Commercial Principal Building Addition (explain) \_\_\_\_\_  
 Commercial Accessory Building (explain) \_\_\_\_\_  
 Commercial Accessory Building Addition (explain) \_\_\_\_\_  
 Commercial Other (explain) \_\_\_\_\_  
 Special/Conditional Use (explain) \_\_\_\_\_  
 External Improvements to Principal Building (explain) \_\_\_\_\_  
 External Improvements to Accessory Building (explain) \_\_\_\_\_

FAILURE TO OBTAIN A PERMIT OR STARTING CONSTRUCTION WITHOUT A PERMIT WILL RESULT IN PENALTIES  
 I (we) declare that this application (including any accompanying information) has been examined by me (us) and to the best of my (our) knowledge and belief it is true, correct and complete. I (we) acknowledge that I (we) am (are) responsible for the detail and accuracy of all information I (we) am (are) providing and that it will be relied upon by Bayfield County in determining whether to issue a permit. I (we) further accept liability which may be a result of Bayfield County relying on this information I (we) am (are) providing in or with this application. I (we) consent to county officials charged with administering county ordinances to have access to the above described property at any reasonable time for the purpose of inspection.

Owner or Authorized Agent (Signature) [Signature] Date 6-14-10  
 Address to send permit P.O. Box 555, Iron River WI, 54847 ATTACH \_\_\_\_\_  
 Copy of Tax Statement or \_\_\_\_\_  
 (If you recently purchased the property Attach a Copy of Recorded Deed)

\* See Notice on Back  
 APPLICANT - PLEASE COMPLETE REVERSE SIDE

Permit Issued: \_\_\_\_\_ State Sanitary Number 367280 Date 2000  
 Date 7/13/10 Permit Number 10-0225 Permit Denied (Date) \_\_\_\_\_  
 Reason for Denial: \_\_\_\_\_  
 Inspection Record: STRUCTURAL SETBACKS/CONDITIONS AS REPRESENTED BY ASSESS APPEALS TO BE CODE  
COMPLETED & I.D. PERMIT MAY BE ISSUED. By DXC Date of Inspection 6-29-10  
 Mitigation Plan Required: Yes  No  Variance (B.O.A.) # \_\_\_\_\_  
 Condition: \_\_\_\_\_  
 Rec'd for REVIEW PREVIOUS PERMITS Signed [Signature] Date of Approval 6-29-10  
07-555 Inspector [Signature] Rec'd for Issuance  
JUL 13 2010

Lot Line

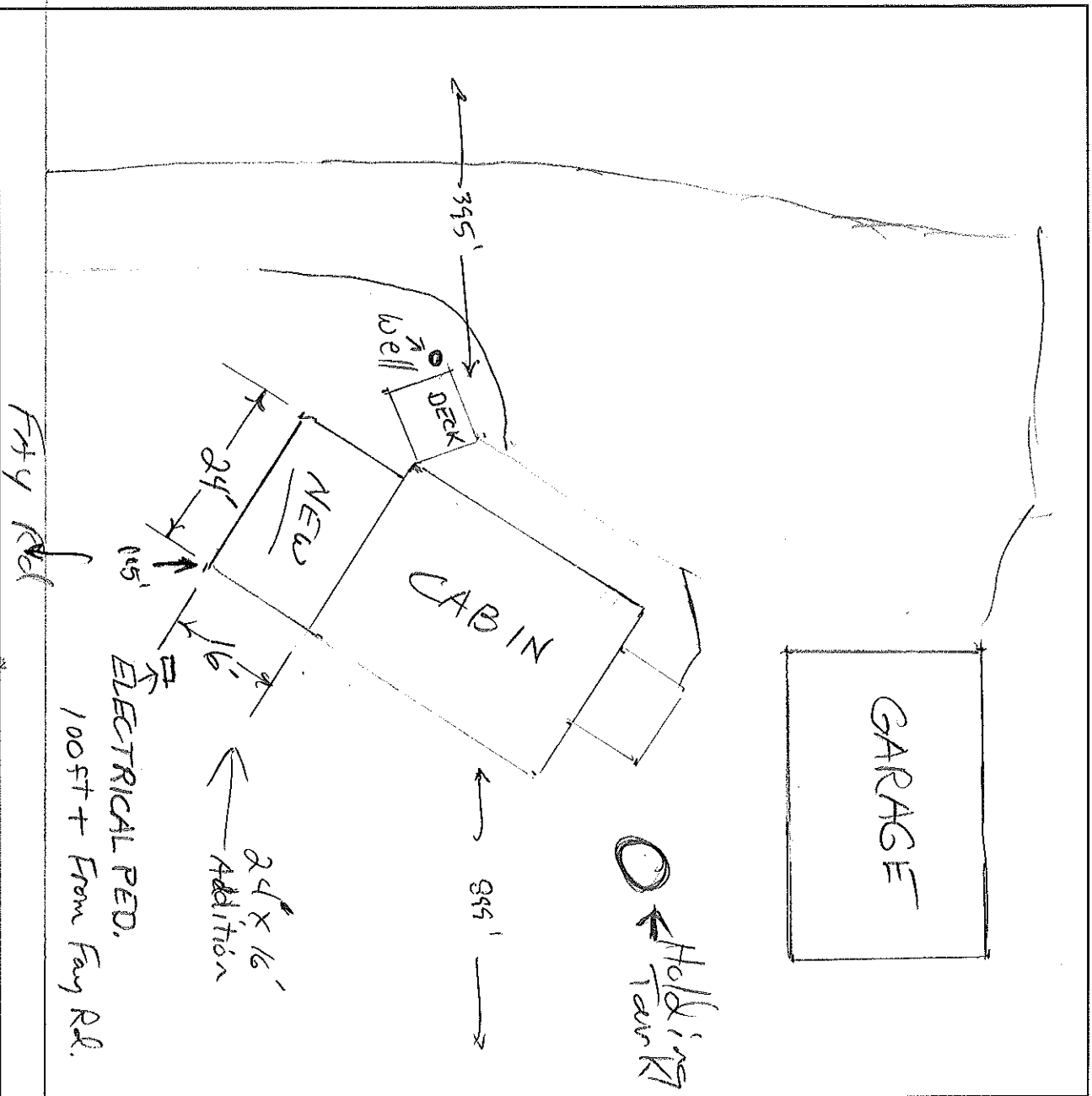

Note: Proposed Addition Not Permitted & Inspected  
 Name of Frontage Road (Fay Rd )

1. Name the frontage road and use as a guideline, fill in the lot dimensions and indicate North (N).
2. Show the location, size and dimensions of the structure.
3. Show the location, size and dimensions of attached deck(s), porch(s) or garage.
4. Show the location of the well, holding tank, septic tank and drain field.
5. Show the location of any lake, river, stream or pond if applicable.
6. Show the location of other existing structures.
7. Show the location of any wetlands or slopes over 20 percent.
8. Show dimensions in feet on the following:
 

<ol style="list-style-type: none"> <li>a. Building to all lot lines</li> <li>b. Building to centerline of road</li> <li>c. Building to lake, river, stream or pond</li> <li>d. Holding tank to closest lot line</li> <li>e. Holding tank to building</li> <li>f. Holding tank to well</li> <li>g. Holding tank to lake, river, stream or pond</li> <li>h. Privy to closest lot line</li> </ol>	<ol style="list-style-type: none"> <li>i. Privy to building</li> <li>j. Privy to lake, river, stream or pond</li> <li>k. Septic Tank and Drain field to closest lot line</li> <li>l. Septic Tank and Drain field to building</li> <li>m. Septic Tank and Drain field to well</li> <li>n. Septic Tank, and Drain field to lake, river, stream or pond.</li> <li>o. Well to building</li> </ol>
--	---

**IMPORTANT**  
 DETAILED PLOT PLAN  
 IS NECESSARY, FOLLOW  
 STEPS 1-8 (a-o) COMPLETELY

\*NOTICE: All Land Use Permits Expire One (1) Year From The Date Issued.

For The Construction Of New One & Two Family Dwellings: ALL Municipalities Are Required To Enforce The Uniform Dwelling Code.  
 You Must Contact Your Town Chairman / Clerk For More Information.

The local town, village, city, state or federal agencies may also require permits.

Stake or mark proposed location(s) of new building, holding tank, septic, drain field, privy, and well. Inspector will not make an inspection until location(s) are staked or marked.