

SUBMIT COMPLETED ORIGINAL APPLICATION, TAX STATEMENT AND FEE TO:
 Bayfield County Zoning Department
 P.O. Box 58
 Washburn, WI 54891
 (715) 373-6138

APPLICATION FOR PERMIT
 BAYFIELD COUNTY, WISCONSIN

RECEIVED
 NOV 03 2011

Bayfield Co. Zoning Dept.

Application No.: 11-04088
 Date: 11/14/11
 Zoning District: R-1
 Amount Paid: \$75.113/11 EAM

INSTRUCTIONS: No permits will be issued until all fees are paid. Checks are made payable to: Bayfield County Zoning Department. DO NOT START CONSTRUCTION UNTIL ALL PERMITS HAVE BEEN ISSUED TO APPLICANT. Changes in plans must be approved by the Zoning Department.

LAND USE SANITARY PRIVY CONDITIONAL USE SPECIAL USE B.O.A. OTHER _____

New Use Tax Statement for Legal Description
 Gov't Lot 850 Lot _____ Block _____ Subdivision _____ CSM # _____ Acreage 4.8
 Legal Description NW 1/4 of E6 1/4 of Section 35 Township 50 North, Range 8 West, Town of Port Cuming

Volume 812 Page 87 of Deeds Parcel I.D. 04-022-2-50-08-35-4-02-000-2002

Property Owner Corn Hoag Land Contractor SELF (Phone) _____

Address of Property 11590 Flagg River Rd Plumber _____ (Phone) _____
Port Cuming, WI

Telephone 715 77431616 Authorized Agent _____ (Phone) _____
 (Work)

Is your structure in a Shoreland Zone? Yes No If Yes, Distance from Shoreline: greater than 75' 75' to 40' less than 40'

Structure: New _____ Addition Existing Basement: Yes _____ No Number of Stories 1

Fair Market Value 16,000 Square Footage 576 Sanitary: New _____ Existing Privy _____ City _____

USE: Residential or Principal Structure (# of bedrooms) _____ Type of Septic/Sanitary System HT

Residence sq. ft. _____ Mobile Home (manufactured date) _____

Residence w/deck-porch (# of bedrooms) _____ Commercial Principal Building _____

Residence sq. ft. _____ Porch sq. ft. _____ Commercial Principal Building Addition (explain) _____

Deck sq. ft. _____ Deck(2) sq. ft. _____ Commercial Accessory Building (explain) _____

Residence w/attached garage (# of bedrooms) _____ Commercial Accessory Building Addition (explain) _____

Residence sq. ft. _____ Garage sq. ft. _____ Commercial Other (explain) _____

Residential Addition / Alteration (explain) _____ Special/Conditional Use (explain) _____

Residential Accessory Building Addition (explain) Storage External Improvements to Principal Building (explain) _____

Residential Other (explain) _____ External Improvements to Accessory Building (explain) _____

FAILURE TO OBTAIN A PERMIT OR STARTING CONSTRUCTION WITHOUT A PERMIT WILL RESULT IN PENALTIES
 I (we) declare that this application (including any accompanying information) has been examined by me (us) and to the best of my (our) knowledge and belief it is true, correct and complete. I (we) acknowledge that I (we) am (are) responsible for the detail and accuracy of all information I (we) am (are) providing and that it will be relied upon by Bayfield County in determining whether to issue a permit. I (we) further accept liability which may be a result of Bayfield County relying on this information I (we) am (are) providing in or with this application. I (we) consent to county officials charged with administering county ordinances to have access to the property described property at any reasonable time for the purpose of inspection.
 Owner or Authorized Agent (Signature) David Hoag Land Date Nov 8, 2011
 Address to send permit 11590 Flagg River Rd, Port Cuming, WI 54865

* See Notice on Back
 APPLICANT - PLEASE COMPLETE REVERSE SIDE
 Copy of Tax Statement or (if you recently purchased the property Attach a Copy of Recorded Deed)

Permit issued: _____ State Sanitary Number _____ Date _____
 Permit Number 11-04088 Permit Denied (Date) _____

Reason for Denial: _____
 Inspection Record: Photoed critical worktop & on canvas representatives advise that specific requirements were met & no permit was issued on Sunday Date of Inspection 11-10-11
 Mitigation Plan Required: Yes No Variance (B.O.A.) # _____
 Condition: _____

~~Bayfield Zoning~~ Rec'd for Issuance NOV 14 2011 Signed [Signature] Inspector KCO-11 Date of Approval _____

Secretarial Staff



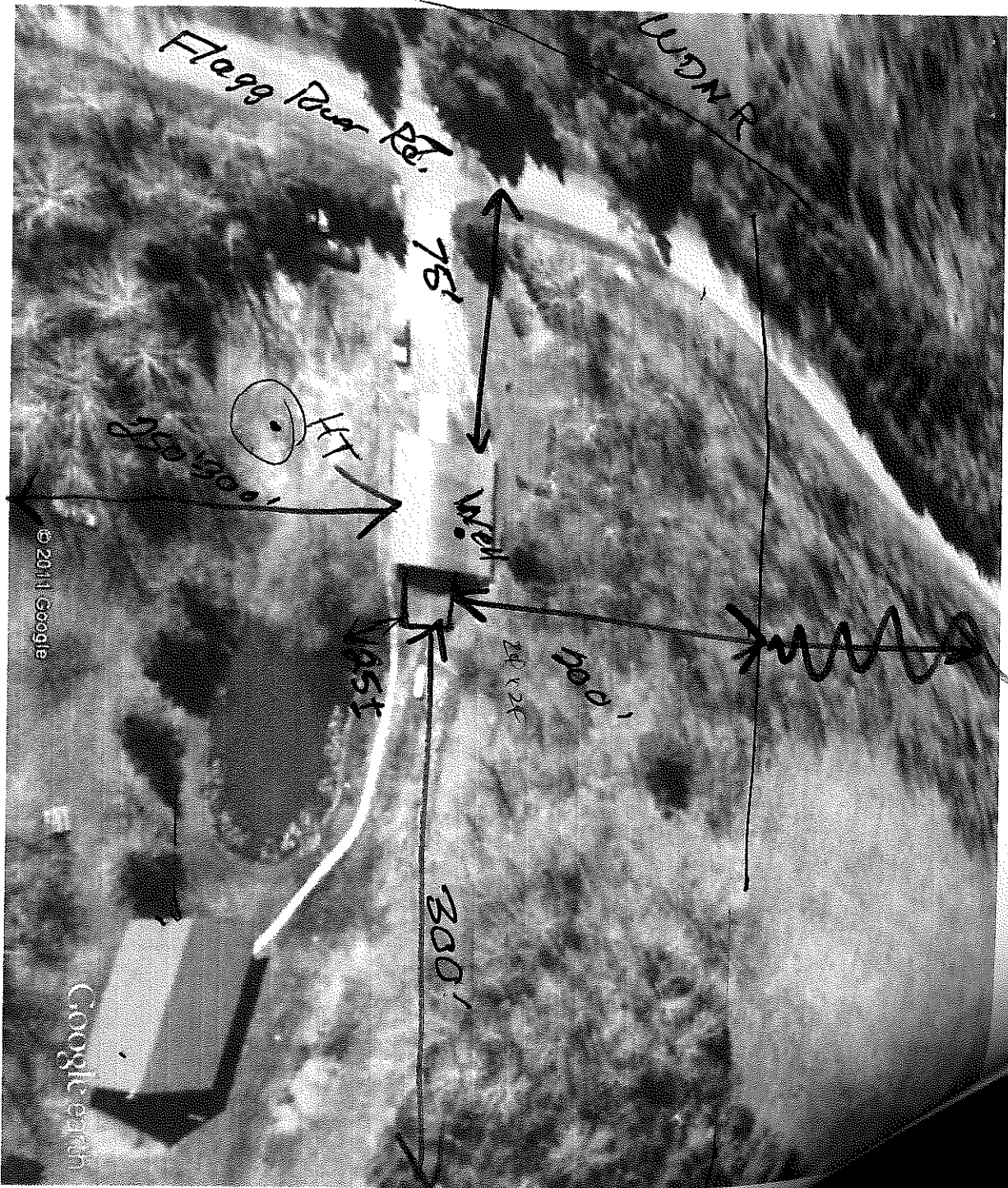

Google earth

feet
meters

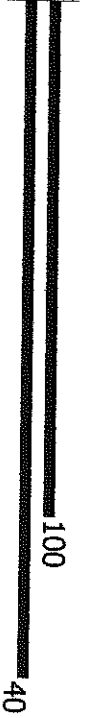

24x24 addition to rear

