

# Bayfield County Forestry & Parks Department

Forester: Joanna Delegan	Twp: 45N	Range: 9W	Sec: 4, 3, 10, & 9	<b>Estimated Volumes:</b> <table border="1"> <thead> <tr> <th>Species</th> <th>4" Cords</th> </tr> </thead> <tbody> <tr> <td>Jack Pine</td> <td>459</td> </tr> <tr> <td>Aspen</td> <td>344</td> </tr> <tr> <td>Mixed Hardwood*</td> <td>86</td> </tr> <tr> <td>Scrub Oak</td> <td>37</td> </tr> <tr> <td>Red Pine**</td> <td>13</td> </tr> </tbody> </table> <p>*Mixed Hardwood approximately: 92% white birch, 8% red maple  **Average DBH of red pine: 14"</p>	Species	4" Cords	Jack Pine	459	Aspen	344	Mixed Hardwood*	86	Scrub Oak	37	Red Pine**	13
Species	4" Cords															
Jack Pine	459															
Aspen	344															
Mixed Hardwood*	86															
Scrub Oak	37															
Red Pine**	13															
Acres: 48	Township: Barnes – North Central															
Soil: Sand	Compartment: 162, 153, 163	Stand: 6, 10, 25														
Regen Code: Jack pine unit - Artificial regen Aspen unit- Natural regeneration	Tract Number: 08-14															
Topography: flat	Contract Number:															
Scale: 4 in. = 1 mile																

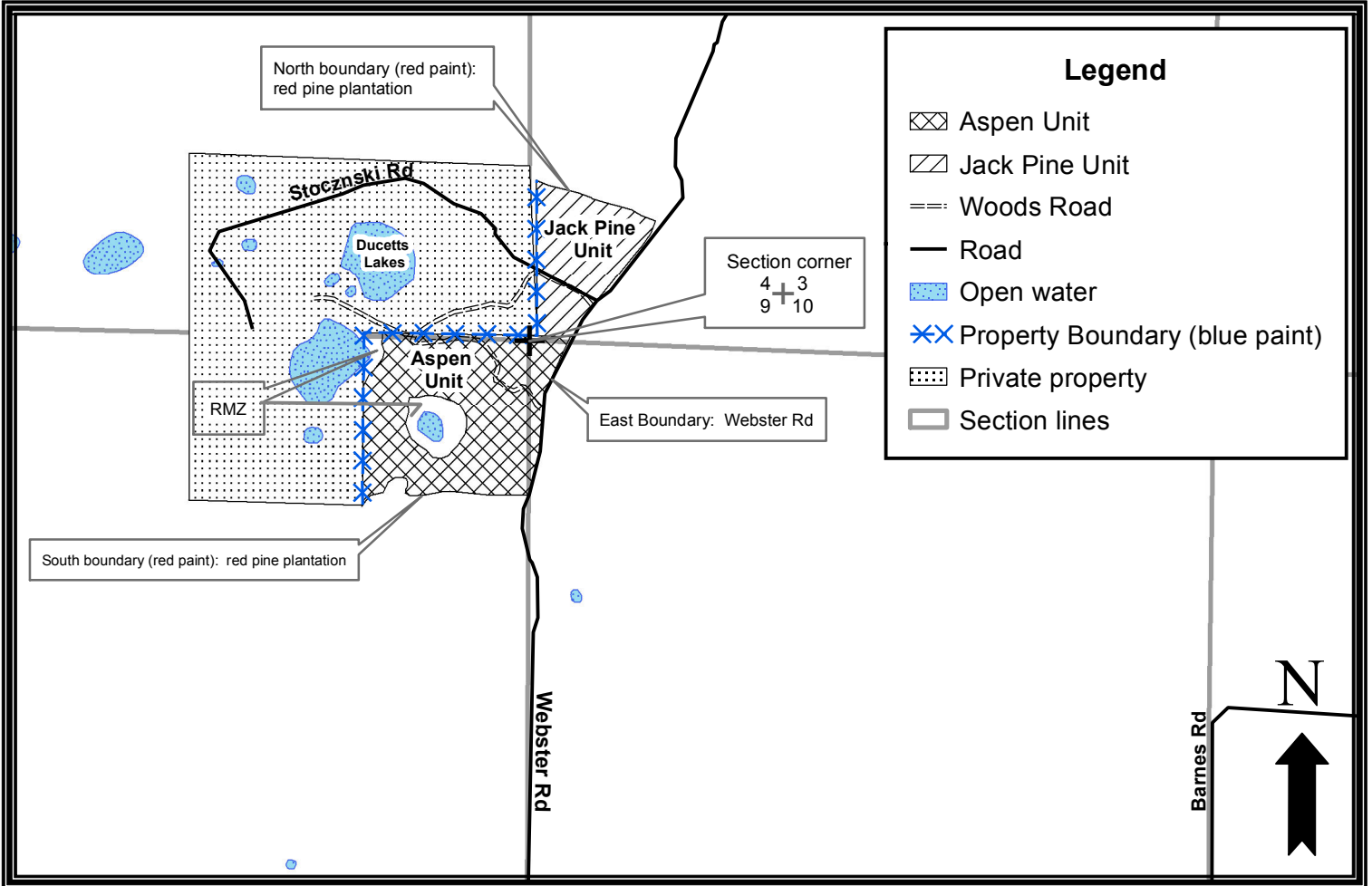

## Harvest requirements:

- Sale is being sold on a ticket scale basis. Whole-tree harvesting and/or utilization of tops less than 4" diameter will not be allowed.
- Sale boundaries and internal boundaries consist of red paint lines, Webster Road (east), and blue line along the west and north property boundaries.
- **Aspen and Jack pine unit:** Cut all jack pine, red pine, and hardwood stems 2" DBH and greater.
- **Aspen unit:** Leave all conifer (except jack pine and red pine). **Jack pine unit:** Harvest all trees 2" DBH and greater.
- **Aspen unit:** Retain all snags that do not pose a direct safety hazard to logging operations. **Jack pine unit:** Remove all snags for site preparation/planting purposes.
- Prior to moving equipment to and from the sale area, scrape soil and debris from exterior surfaces.
- This contract requires County authorization for all road/landing construction, and places a number of other requirements on road construction and closure.
- Decking of wood along town roads will not be allowed without permission from Bayfield County.
- Do not damage any survey monumentation.
- Harvested pine cannot be kept on the Bayfield County Forest for more than three weeks from May 1<sup>st</sup> to August 31<sup>st</sup>.