

Bayfield County Forestry and Parks

Forester: LeBouton	Twp: 47N	Range: 09	Sec: 32	Estimated Volumes:			
Acres: 52	Township: Hughes			Species	4" Cords	Whole Tree Tons	MBF
Soil: Sand	Compartment: 121	Stand: 47		Red Oak	476	2290	55
Topography: Rolling	Tract Number: 14-14	Reforestation Code: Natural		Mixed Hardwood *	231	730	
Scale: 4" = 1 mile	Contract Number:			Aspen	325	1000	

*Mixed Hardwood = 75% red maple, 15% hard maple, 10% white birch.

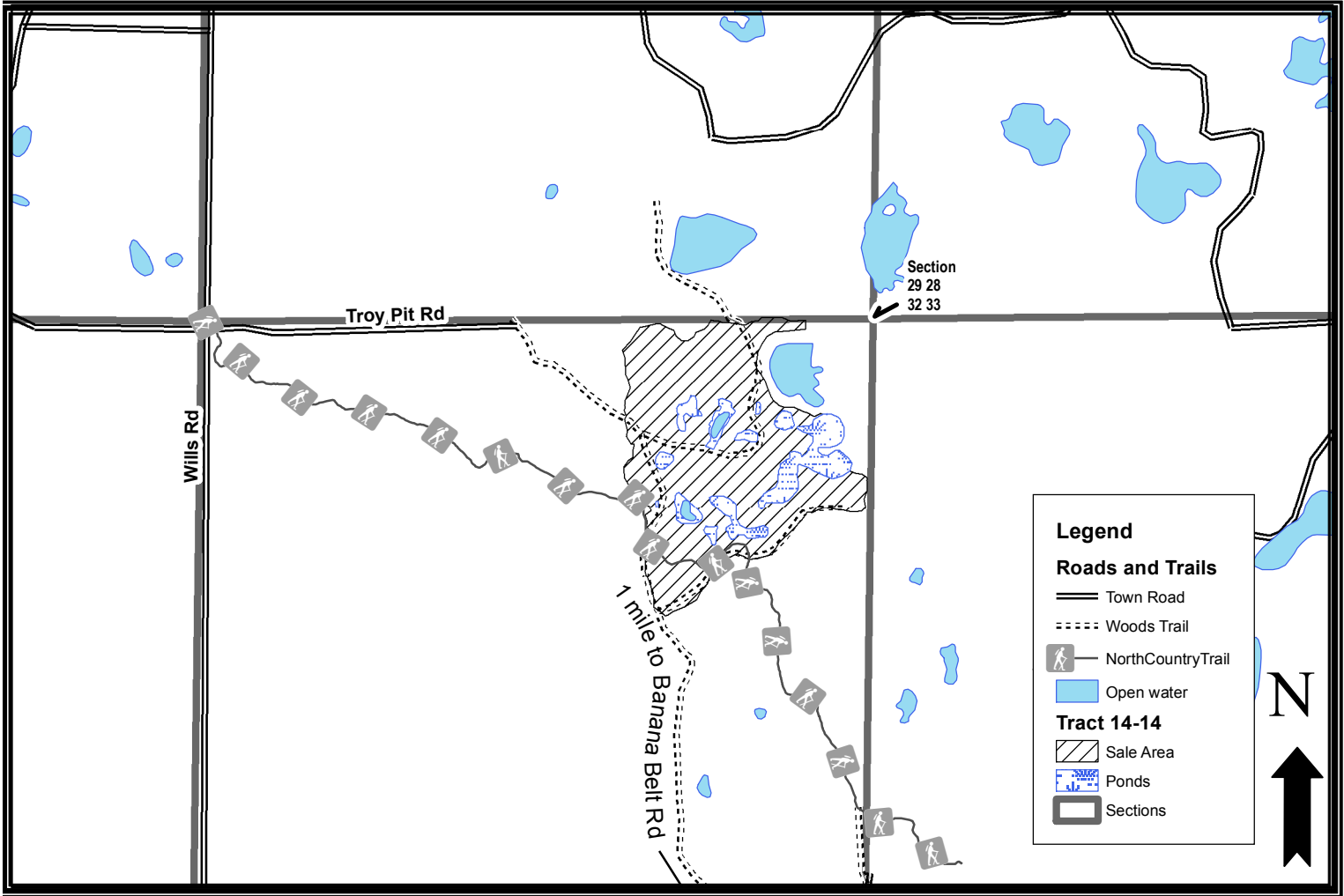

Harvest requirements:

- This is a ticket sale.
- If the whole tree is utilized, leave one in ten tops scattered in the sale area.
- Do not harvest within 30ft (approximately one-half tree height) of ponds and wet areas within stand boundary.
- Sale boundaries are red paint lines.
- Cut all oak, maple, birch, and aspen 2 inches DBH and greater, EXCEPT do not cut purple-painted trees.
- DO NOT CUT red pine or white pine.
- GROUSE DRUMMING LOGS: This sale includes 11 trees that are painted with a red "X." Operator must fell and leave all trees marked with a red "X." "X" marked trees should be cut 5ft above ground level and should lie as close to the high stump as possible. These trees will create ruffed grouse drumming habitat.
- Keep slash height 18" or less within 25ft of the North Country Trail. Do not cut any blue-marked trees along the North Country Trail. Trail must be returned to pre-sale condition as determined by Sale Administrator. Keep Trail crossings to a minimum. No decking, landing, or hauling on Trail.
- Prior to moving equipment on to or off the sale area, scrape or brush debris and soil from exterior surfaces.
- All roads are in place. This contract requires county authorization for all road/landing construction and places a number of other requirements on road construction and closure.
- Decking of wood along town roads will not be allowed without permission of Bayfield County.