

Bayfield County Forestry & Parks Department

| | | | |
|----------------------------------------------|------------------------|----------------------------|-------------|
| Foresters: Holmes, Amman, DNR | Twp: 43N | Range: 7W | Sec: 26, 27 |
| Acres: 44 | Township: Cable (East) | | |
| Soil: Sand | Compartment: 197 | Stand: P5 | |
| Topography: Gentle Rolling - Steep Slopes | Tract Number: 25-14 | Reforestation Code: N/A | |
| Scale: 4"=1 mile | Contract Number: | | |

Estimated Volume

| Species | Whole Tree (Tons) | Roundwood (Cords) |
|----------|-------------------|-------------------|
| Red Pine | 1145 | 377 |

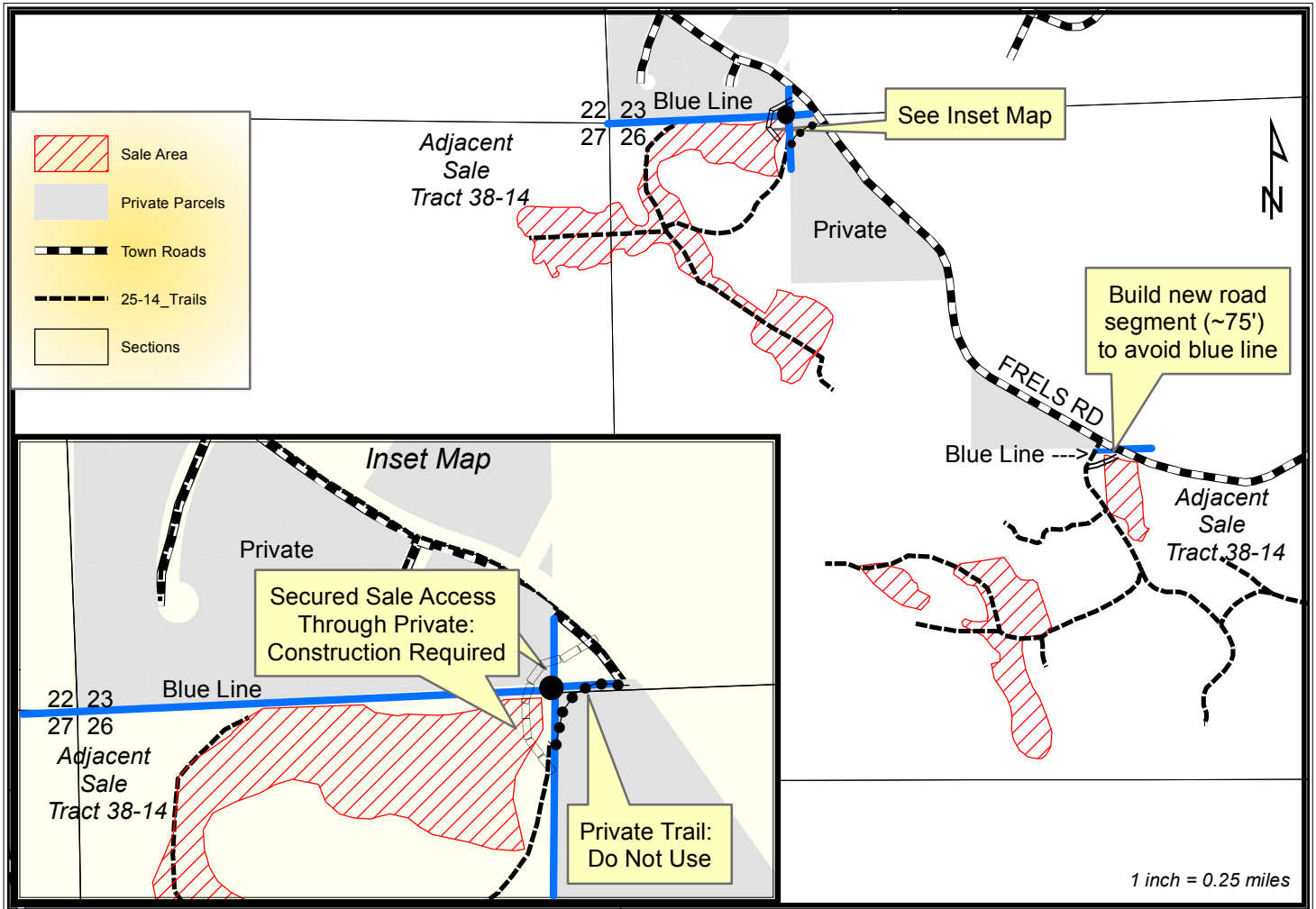

Harvest Requirements:

- This sale is a 44-acre red pine 2nd thinning sold on a Ticket Scale Basis.
- Sale boundaries are identifiable on the ground by abrupt changes in timber types (adjacent oak and aspen) or blue line along private property.
- In the western portion of the sale, the buyer will need to build a new access road. This new road will cross through the corner of private property in section 23 and will skirt a survey monument before re-entering Bayfield County ownership. In the far eastern portion of the sale, the buyer will need to build a short segment of road (about 75') that will avoid the blue line by re-routing further east to connect to Frels Road.
- **Harvest all orange-painted red pine**
- If whole-tree harvested, 1 in 10 tops less than or equal to 4" diameter must be left scattered across the site.
- Minimize damage to residual red pine stand.
- No harvested trees and no equipment may cross the blue line.
- Harvested pine cannot be kept on the Bayfield County Forest for more than 3 weeks from May 1st to August 31st.
- Do not damage any survey monuments.
- To comply with the Best Management Practices for Invasive Species: Prior to moving equipment onto or off of the sale area, scrape or brush soil and debris from exterior surfaces of the logging equipment.
- Decking of wood along town roads will not be allowed without permission from Bayfield County Forestry Department
- This contract requires County authorization for all road/landing construction and places a number of other requirements on road construction and closure. (refer to Section 17)