

Bayfield County Forestry & Parks Department

Foresters: Holmes, L. Neitzel	Twp: 47N	Range: 9W	Sec: 31
Acres: 4	Township: Hughes		
Soil: Sand	Compartment: 120	Stand: 14	
Topography: Gently Rolling	Tract Number: 31-14	Reforestation Code: Artificial	
Scale: 4"=1 mile	Contract Number:		

Estimated Volumes

Species	Roundwood	Whole Tree
	Cords	Tons
Red Pine*	182	529
White Pine	28	80
Mixed Hardwood**	6	17

*69.2% total volume in 18" DBH and larger size class

**Approx. 58% red oak, 40% white birch, 1% aspen and 1% other hardwood.

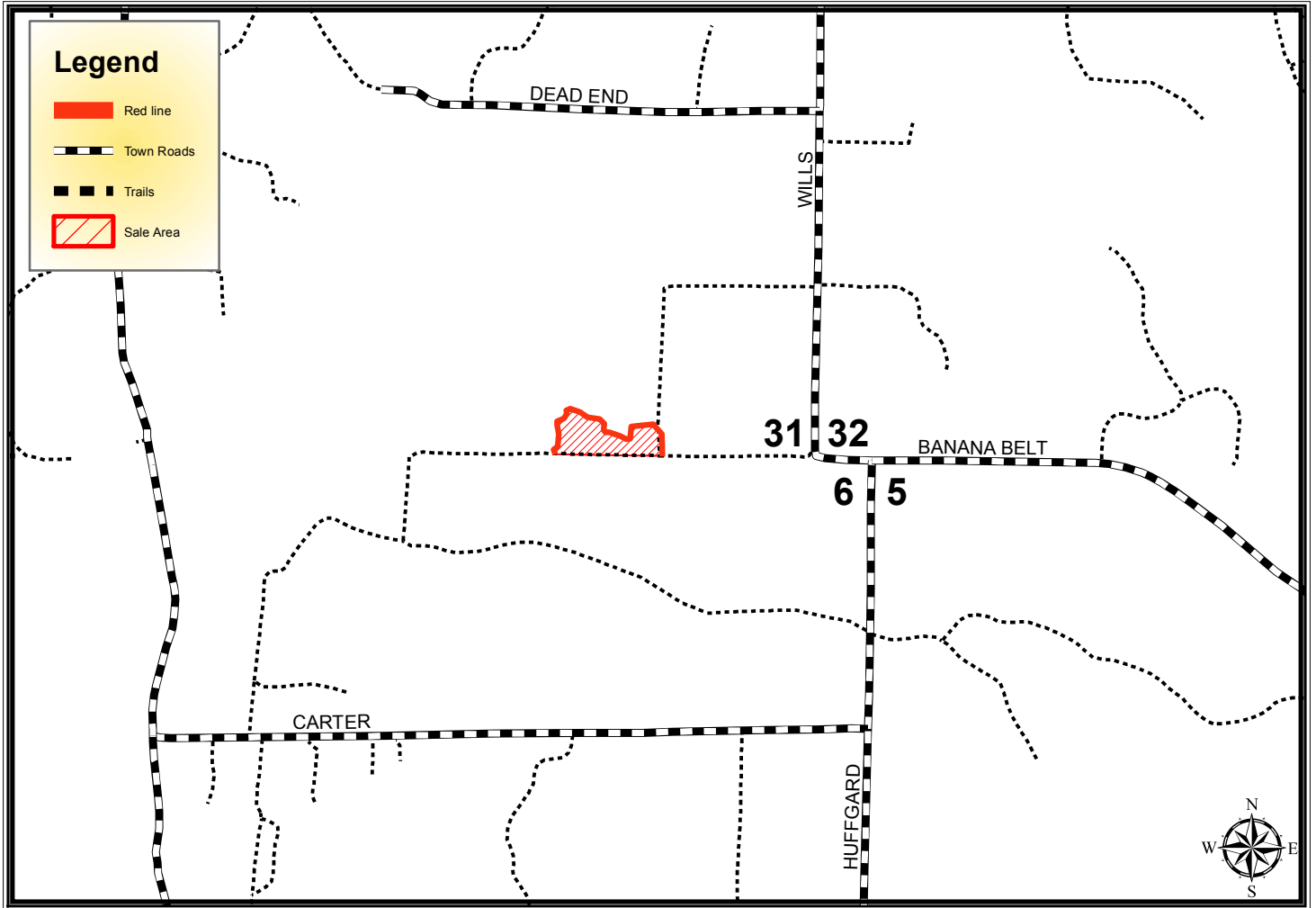

Harvest Requirements:

1 inch = 0.25 miles

- This sale is a red pine clearcut being sold on a Ticket Scale Basis.
- Sale boundaries are identifiable on the ground by a forest road to the south and red line.
- Harvest all merchantable timber within the sale area. Sever all stems greater than 2" in diameter. Cut all snags.
- If whole-tree harvested, 1 in 10 tops $\leq 4''$ in diameter must be left scattered across the site.
- Harvested pine cannot be kept on the Bayfield County Forest for more than 3 weeks from May 1st to August 31st.
- Do not damage any survey monuments.
- To comply with the Best Management Practices for Invasive Species: Prior to moving equipment onto or off of the sale area, scrape or brush soil and debris from exterior surfaces of the logging equipment.
- Decking of wood along town roads will not be allowed without permission from Bayfield County Forestry Department
- This contract requires County authorization for all road/landing construction and places a number of other requirements on road construction and closure. (refer to Section 17)