

Bayfield County Forestry & Parks Department

Foresters: County	Twp: 50N	Range: 6W	Sec: 29
Acres: 80	Township: Bell		
Soil: Sand	Compartment: 44/45	Stand: 2&25/8&30	
Topography: Moderate Slopes	Tract Number: 40-14	Reforestation Code: NA	
Scale: 4"=1 mile	Contract Number:		

Estimated Volumes

Species	Roundwood Cords	Logs MBF
Red Oak	1282	43
Mixed Hardwood *	398	
Aspen	491	
White Pine	88	
Red Pine **	139	
Balsam Fir	257	

*Approx 50% red maple, 34% hard maple, 15% white birch and 1% other hardwoods
**Approximately 89% red pine and 11% jack pine

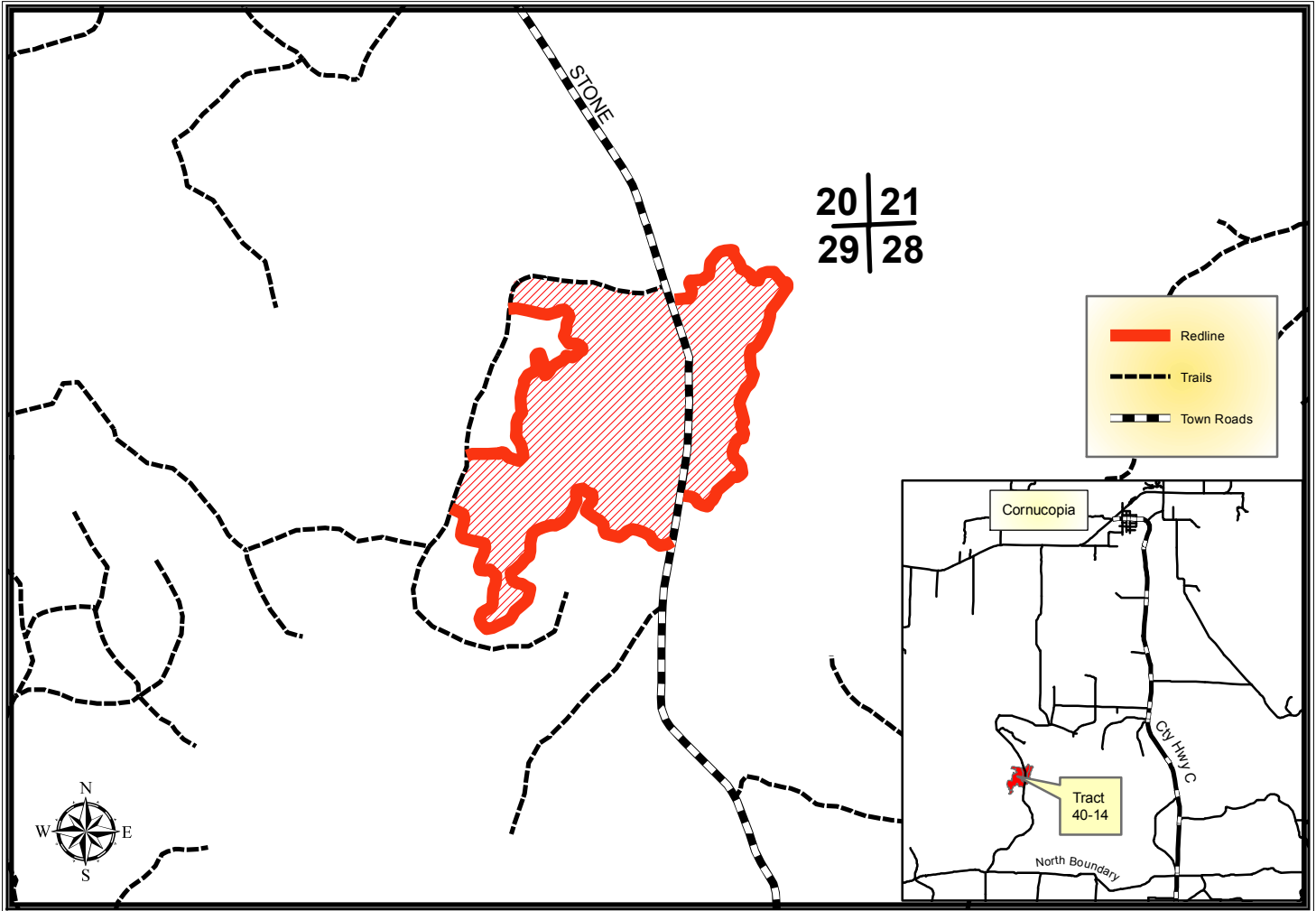

Harvest Requirements:

1 inch = 0.25 miles

- This sale is a seed tree and clear cut being sold on a Ticket Scale Basis.
- Sale boundaries are identifiable on the ground by painted red line and a forest road on the northwestern portion of the stand.
- Harvest all merchantable timber. Do not harvest any purple-marked trees (oak, red pine, white pine, white birch, red maple or aspen). Do not harvest any oak 6" DBH or smaller.
- Sever all non-merchantable hardwood stems (2" DBH and greater) except oak and aspen.
- Cut and leave in place three (3) orange-ringed trees (grouse drumming log recruitment) within the sale boundary. Cut orange-ringed trees at 5-feet above ground level and place severed bole as close to the stump as possible to create suitable drumming site.
- Minimize damage to residual stand. There are a few small aspen clones (2" DBH and smaller) scattered throughout the site.
- Whole tree harvesting and/or utilization of tops (equal to or less than 4" diameter) will not be allowed.
- Do not cut snags except for individuals that pose a safety hazard.
- Do not damage any survey monuments.
- To comply with the Best Management Practices for Invasive Species: Prior to moving equipment onto or off of the sale area, scrape or brush soil and debris from exterior surfaces of the logging equipment.
- Decking of wood along town roads will not be allowed without permission from Bayfield County Forestry Department
- This contract requires County authorization for all road/landing construction and places a number of other requirements on road construction and closure.