

Bayfield County Forestry and Parks

Forester: LeBouton	Twp: 47N	Range: 09W	Sec: 36	Estimated Volumes:			
Acres: 96	Township: Hughes - North			Species	4" cords	WT Tons	MBF
Soil: Sand	Compartment: 117	Stand: 4, 9, & 10		Aspen	*910	2820	
Topography: Rolling	Tract Number: 16-17	Reforestation Code: natural		Red oak	190	620	41
Scale: 4" = 1 mile	Contract Number:			Red maple	110	360	
				Jack pine	180	490	
				* includes approximately 80 cords of white birch			

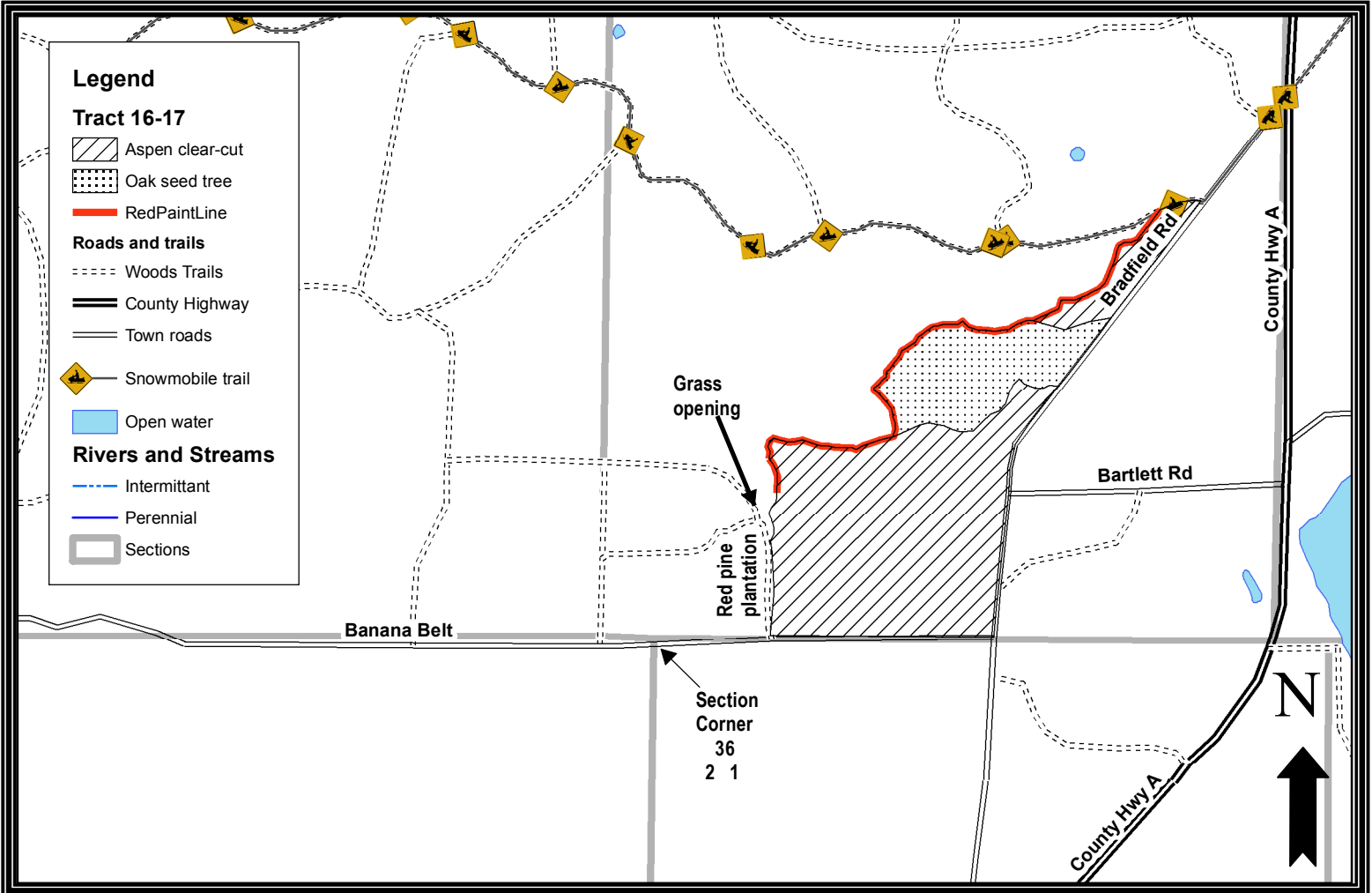

Harvest requirements:

- This is a ticket sale. Sale boundaries consist of red paint line, town roads, or an abrupt change of cover type including a red pine plantation and a grassy opening on the west. DO NOT use the grassy opening as a landing.
- HARVEST all trees greater than 4" diameter at breast height, and sever all other stems 2" and larger, EXCEPT:
- LEAVE purple-painted trees, white pine, and red pine.
- If the whole tree is to be harvested, leave one in ten tops scattered in the sale area.
- Do not cut snags except for individuals that pose a safety hazard.
- During winter harvesting the snowmobile trail must be kept unobstructed and in a packed snow condition. The purchaser must insure that harvesting and hauling operations will not create a safety hazard to snowmobiles.
- Do not damage any survey monumentation.
- Prior to moving equipment on to or off the sale area, scrape or brush debris and soil from exterior surfaces.
- All roads are in place. This contract requires county authorization for all road/landing construction and places a number of other requirements on road construction and closure.
- Decking of wood along town roads will not be allowed without permission of Bayfield County.
- This sale includes about 12 trees that are painted with a purple "X". Operator must fell and leave all trees marked with a purple "X". "X" marked trees should be cut 5 ft above ground level and should lie as close to the high stump as possible. These trees will create ruffed grouse drumming habitat.