

Bayfield County Forestry & Parks Department

Forester: Andrew O'Krueg			Acres: 107
Twp: 50N	Range: 7W	Sec: 31	Compartment: 77
Township: Clover			Stand: 6,24
Soil: Clay, Muck		Reforestation Code: N/A	Tract Number: 44-17
Topography: Gently Rolling			Contract Number:

Species	Estimated Volumes		
	Roundwood	Whole tree	Logs
	Cords	Tons	MBF
Aspen***	1417	4586	
Mixed Hardwood	425*	1482	10**
Ash	302	1062	
Fir/Spruce	105	444	

* approx. 85% Maple, 7% oak, 6% basswood, 1% white birch, 1% other hardwood
 ** approx. 70% maple, 20% ash, 9% basswood, 1% other hardwood
 ***Ave. DBH is 7"

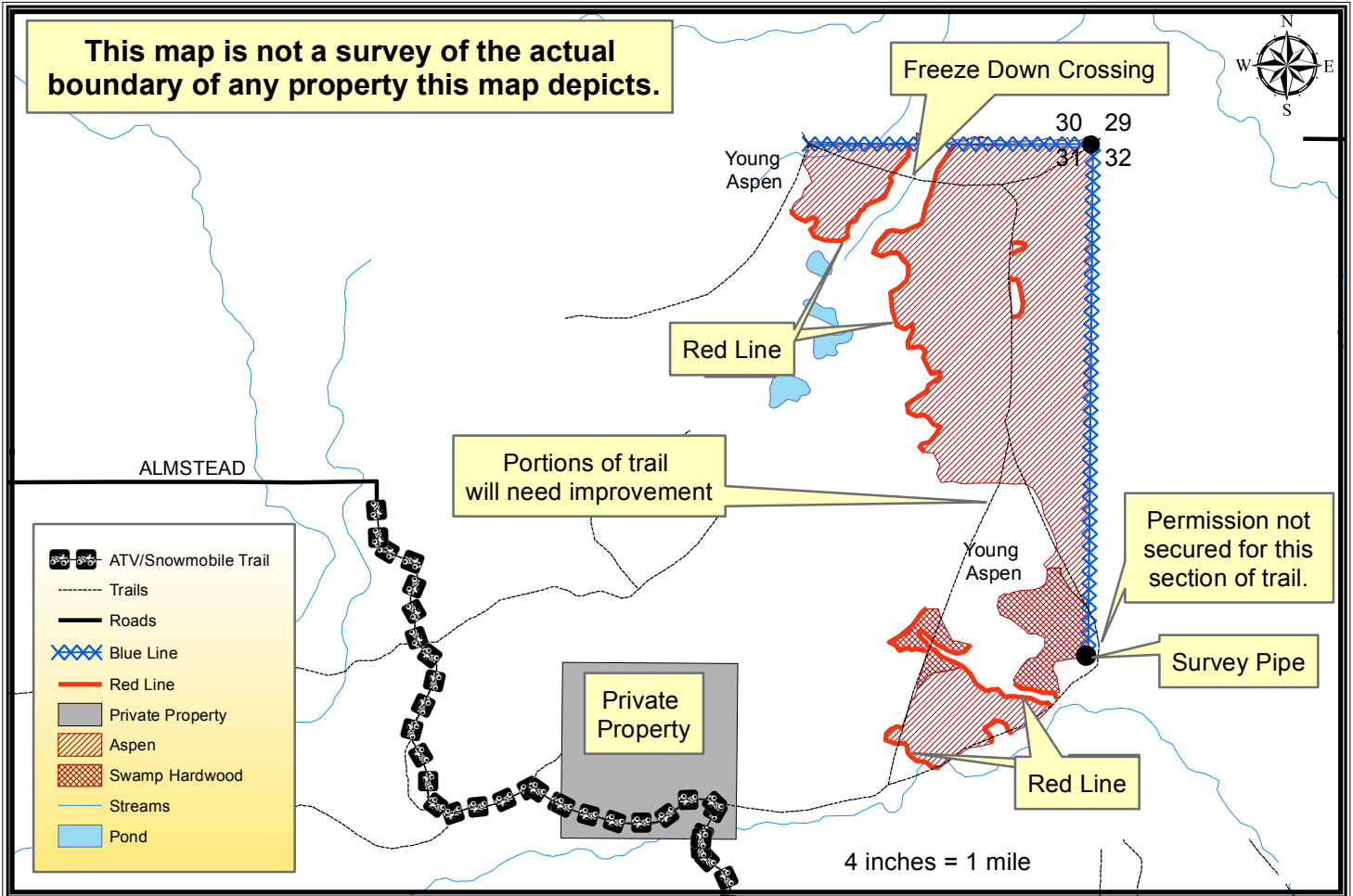

- Harvest Requirements:**
- Sale is a clearcut being sold on a Ticket Scale Basis
 - Cut all hardwood stems 2 inches in diameter and greater except oak 10 inches in diameter and greater. Cut all spruce and firstems 2 inches in diameter and greater. Leave all cedar and hemlock. Leave all oak 10 inches in diameter and greater.
 - Sale boundaries consist of red paint line, blue paint line, or abrupt timber type changes to young aspen.
 - Sale operations may only occur when the ground is frozen or exceptionally dry conditions as determined by Bayfield County.
 - There is a frozen water crossing in the northern portion of the sale. The crossing must be installed when the ground is frozen and removed before the ground is thawed. No soil may be disturbed. All work must be done to the satisfaction of the sale administrator.
 - According to the Bayfield County Access management plan the existing roads within this timber sale are closed to highway vehicle use. Prior to the completion of the timber sale roads to be blocked as directed by the sale administrator.
 - The primary haul route utilizes a portion of the ATV/Snowmobile trail. Excessive damage (beyond normal wear and tear) to the ATV trail, as determined by Bayfield County, will not be tolerated. If Bayfield County determines excessive damage has occurred, the Contractor may be held responsible for a portion or all of the repair. The County and Contractor must communicate on a regular basis to ensure issues are addressed in a timely manner and the ATV trail remains in a safe and acceptable condition.
 - During harvest the ATV/snowmobile trail must be kept unobstructed. If operating in the winter the snowmobile trail must be kept in a packed snow condition. The purchaser must ensure that the harvesting and hauling operations will not create a safety hazard. Avoid damage to signs and trail markers.
 - The blue line indicates private property. No equipment or felled trees may cross the line.
 - Do not damage any survey monumentation.
 - Access has been secured by Bayfield County.
 - Do not cut snags except for those that pose a safety hazard.
 - To comply with the Best Management Practices for Invasive Species: Prior to moving equipment onto or off of the sale area, scrape or brush soil and debris from exterior surfaces to the extent practical.
 - Decking of wood along town roads will not be allowed without permission from Bayfield County.
 - If harvest will utilize the whole tree, 1 in 10 tops must be left scattered throughout the sale.
 - This contract requires County authorization for all road/landing construction and places a number of other requirements on road construction and closure.