

Bayfield County Forestry and Parks

Forester: LeBouton	Twp: 49N	Range: 07W	Sec: 3 & 10	Estimated Volumes:																		
Acres: 100	Township: Clover			<table border="1"> <thead> <tr> <th>Species</th> <th>4" cords</th> <th>MBF</th> </tr> </thead> <tbody> <tr> <td>Aspen</td> <td>1000</td> <td></td> </tr> <tr> <td>Red oak</td> <td>710</td> <td>116</td> </tr> <tr> <td>Red pine</td> <td>440</td> <td></td> </tr> <tr> <td>Mixed hdwd</td> <td>*110</td> <td>**12</td> </tr> <tr> <td>Basswood</td> <td>20</td> <td></td> </tr> </tbody> </table>	Species	4" cords	MBF	Aspen	1000		Red oak	710	116	Red pine	440		Mixed hdwd	*110	**12	Basswood	20	
Species	4" cords	MBF																				
Aspen	1000																					
Red oak	710	116																				
Red pine	440																					
Mixed hdwd	*110	**12																				
Basswood	20																					
Soil: Sand, clay	Compartment: 79	Stand: 7, 8, & 17																				
Topography: Rolling	Tract Number: 17-16	Reforestation Code: N/A (natural)- presale scarification Stand 7																				
Scale: 4" = 1 mile	Contract Number:			<p>*approximately 67% red maple, 12% hard maple, 10% white birch, 8% ash, and 3% balsam fir. **approximately 36% basswood, 33% red maple, 12% hard maple, 12% ash, and 7% white birch.</p>																		

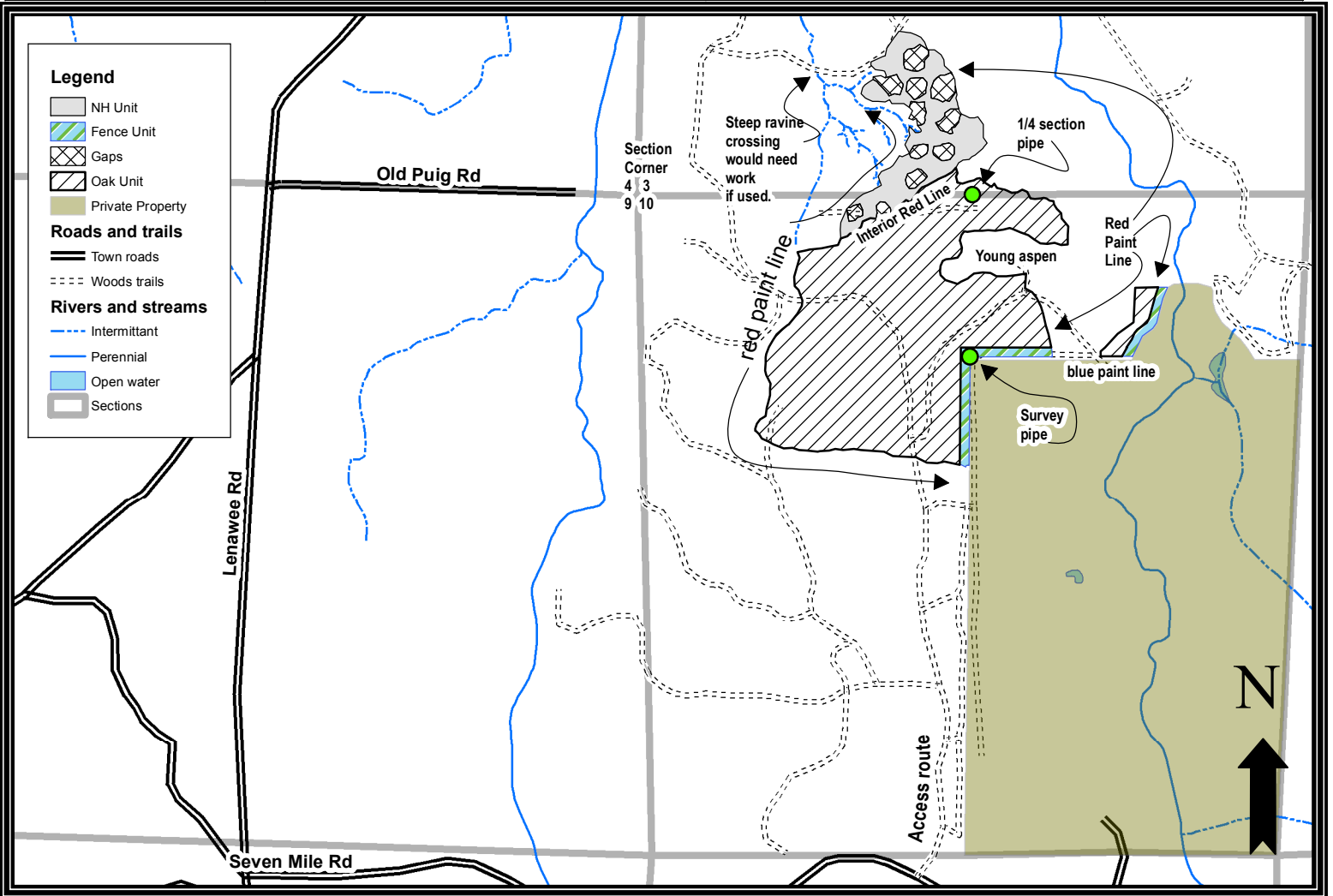

Harvest requirements:

- This is a ticket sale.
- Do not damage any survey monumentation
- This harvest is in three units.
 - NH unit: North of the interior red line, harvest in FROZEN SEASON ONLY. Harvest all trees 2" diameter and larger inside purple-marked gaps. Gaps are indicated by purple paint on 8 to 10 perimeter trees. Two purple dots are painted to face into each gap, and a purple slash is on the back of each perimeter tree.
 - Oak unit: South of the interior red line, cut all trees 2" diameter and larger EXCEPT:
 - do not cut or damage non-merchantable red pine,
 - do not cut or damage white pine of any size, and
 - do not cut purple-marked trees.
 - Fence-line Unit: Cut all trees 2 inches diameter and larger within 66 feet of the fence bordering the sale area.
- Prior to moving equipment on to or off the sale area, scrape or brush debris and soil from exterior surfaces.
- All roads are in place. This contract requires county authorization for all road/landing construction and places a number of other requirements on road construction and closure.
- Decking of wood along town roads will not be allowed without permission of Bayfield County.
- Harvested pine cannot be kept on the Bayfield County Forest for more than three weeks from May 1st to August 31st.
- Property lines depicted on this map are approximate and do not constitute a survey.