

Bayfield County Forestry & Parks Department

Forester: Jason Holmes			Acres: 109	<table border="1"> <thead> <tr> <th colspan="4">Estimated Volumes</th> </tr> <tr> <th>Species</th> <th>Roundwood (cords)</th> <th>Whole-tree (tons)</th> <th>Logs (MBF)</th> </tr> </thead> <tbody> <tr> <td>Red Oak</td> <td>1633</td> <td>5680</td> <td>241</td> </tr> <tr> <td>Aspen</td> <td>657</td> <td>2015</td> <td></td> </tr> <tr> <td>Mixed Hardwood</td> <td>*545</td> <td>1812</td> <td>**6</td> </tr> <tr> <td>Basswood</td> <td>132</td> <td>403</td> <td>5</td> </tr> </tbody> </table>			Estimated Volumes				Species	Roundwood (cords)	Whole-tree (tons)	Logs (MBF)	Red Oak	1633	5680	241	Aspen	657	2015		Mixed Hardwood	*545	1812	**6	Basswood	132	403	5
Estimated Volumes																														
Species	Roundwood (cords)	Whole-tree (tons)	Logs (MBF)																											
Red Oak	1633	5680	241																											
Aspen	657	2015																												
Mixed Hardwood	*545	1812	**6																											
Basswood	132	403	5																											
Twp: 47N	Range: 09W	Sec: 04	Compartment: 105																											
Township: Hughes			Stand: 3,21,33																											
Soil: Sandy Loam	Reforestation Code: Scarify/Fence	Tract Number: 39-16																												
Topography: Rolling Terrain			Contract Number:																											

* Hardwood pulp: approx. 82% maple, 9% white birch, 8% ash, 1% other hardwood
 **Hardwood logs: approx. 95% red maple, 5% other hardwoods

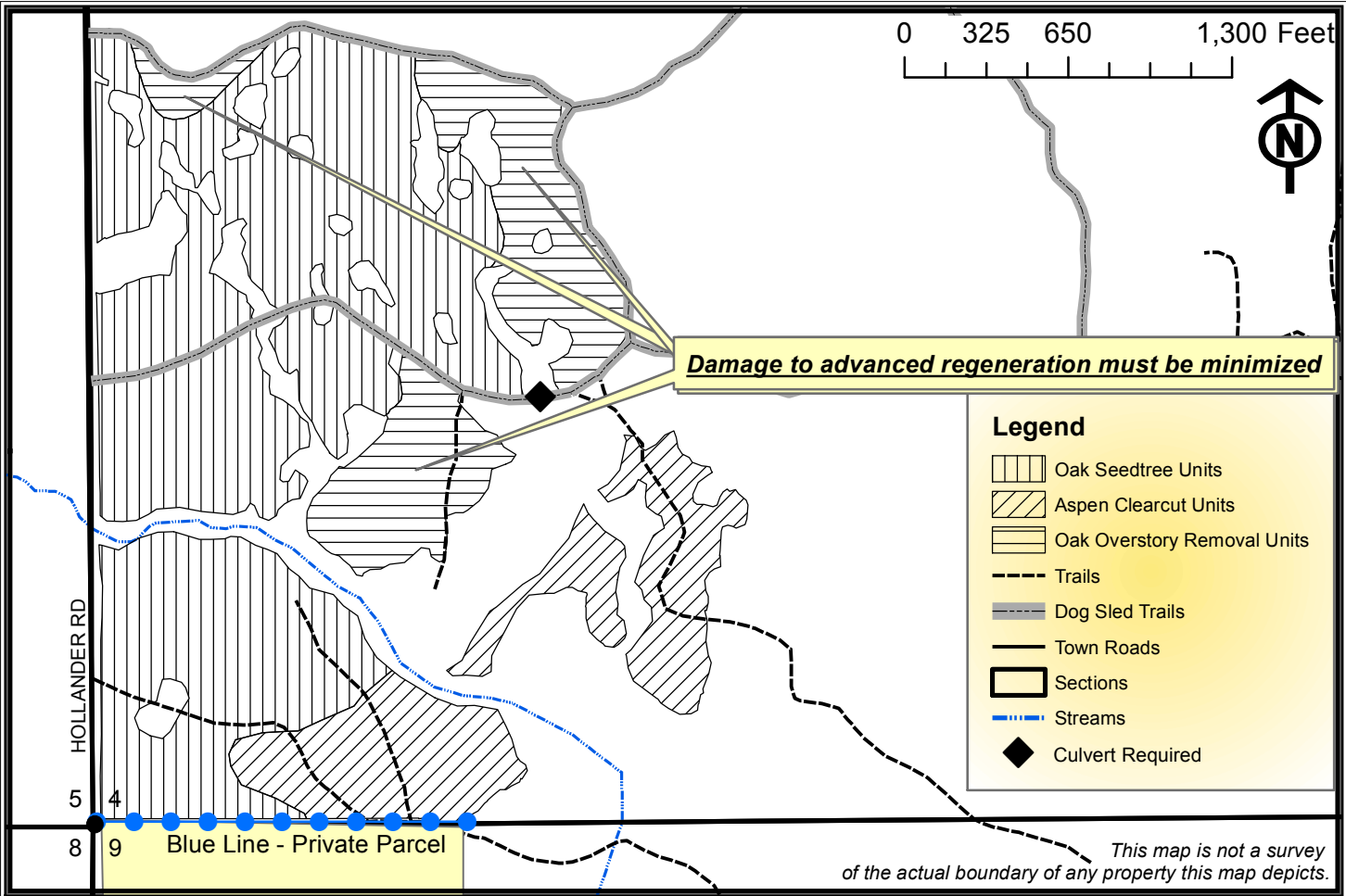

- Sale contains 3 units, 1) oak seed tree 2) aspen clearcut 3) oak overstory removal - all sold on a Ticket Scale Basis
- Sale boundaries are formed by red line, blue line, Hollander Road, and trails. The old, faded red line that exists on the edges of some overstory removal units may be ignored. The blue line indicates private property. No equipment or felled trees may cross the blue line.
- Many wetland areas within the sale are redlined out. Depending on season of harvest and precipitation, soils may be wet in other areas.
- Contractor is required to purchase and install a 12" culvert to improve access at the location shown on the map.
- Keep dogsled trails passable and free of debris, year-round. In winter maintain snow cover on dogsled trails.
- From May 19th to October 16th, care must be taken to avoid open sandy areas with equipment and felled trees due to the possible presence of a rare animal.
- **Prescriptions: Oak Seed-tree & Aspen Clearcut Units:** Leave all purple-marked hardwoods and all conifers. Harvest all merchantable hardwoods not marked with purple paint. Sever all submerchantable stems $\geq 2"$ in diameter. Portions of the oak seed tree units have been scarified to encourage oak establishment. **Oak Overstory Removal Units:** Harvest all merchantable trees that are not marked with purple paint. The point of this harvest is to release young saplings that are present in the understory. **Minimize damage to the regeneration.**
- Grouse Drumming Logs: This sale includes several trees that are painted with a purple "X". Operator must fell and leave in place all trees marked with a purple "X". Leave a 6 foot tall stump (marked with a purple ring), and lay the entire remainder of the tree as close to the stump as possible.
- Do not cut snags except for those that pose a safety hazard. Do not dispose of slash in wetlands.
- To comply with the Best Management Practices for Invasive Species: Prior to moving equipment onto or off of the sale area, scrape or brush soil and debris from exterior surfaces to the extent practical.
- Decking of wood along town roads will not be allowed without permission from Bayfield County.
- If harvest will utilize the whole tree, 1 in 10 tops must be left scattered throughout the sale.
- This contract requires County authorization for all road/landing construction and places a number of other requirements on road construction and closure.