

# Bayfield County Forestry and Parks

Forester: Latvala			Acre: 75	Estimated Volumes:		
Twp: 50N	Range: 7W	Section: 35 & 36	Compartment: 54&55	Species	Round Wood Cords	MBF
Township: Clover			Stand: 16,19&23	MX Hwd*	675	30
Soil: Loamy Sand		Reforestation Code: Natural	Tract Number: 53-16	Red Oak	640	125
Topography: Gently Rolling			Contract Number:	Aspen	175	
				Balsam Fir	35	

\*The MX Hwd volume includes 65% red maple, 15% sugar maple, 13% basswood, 4% white birch & 3% black ash.

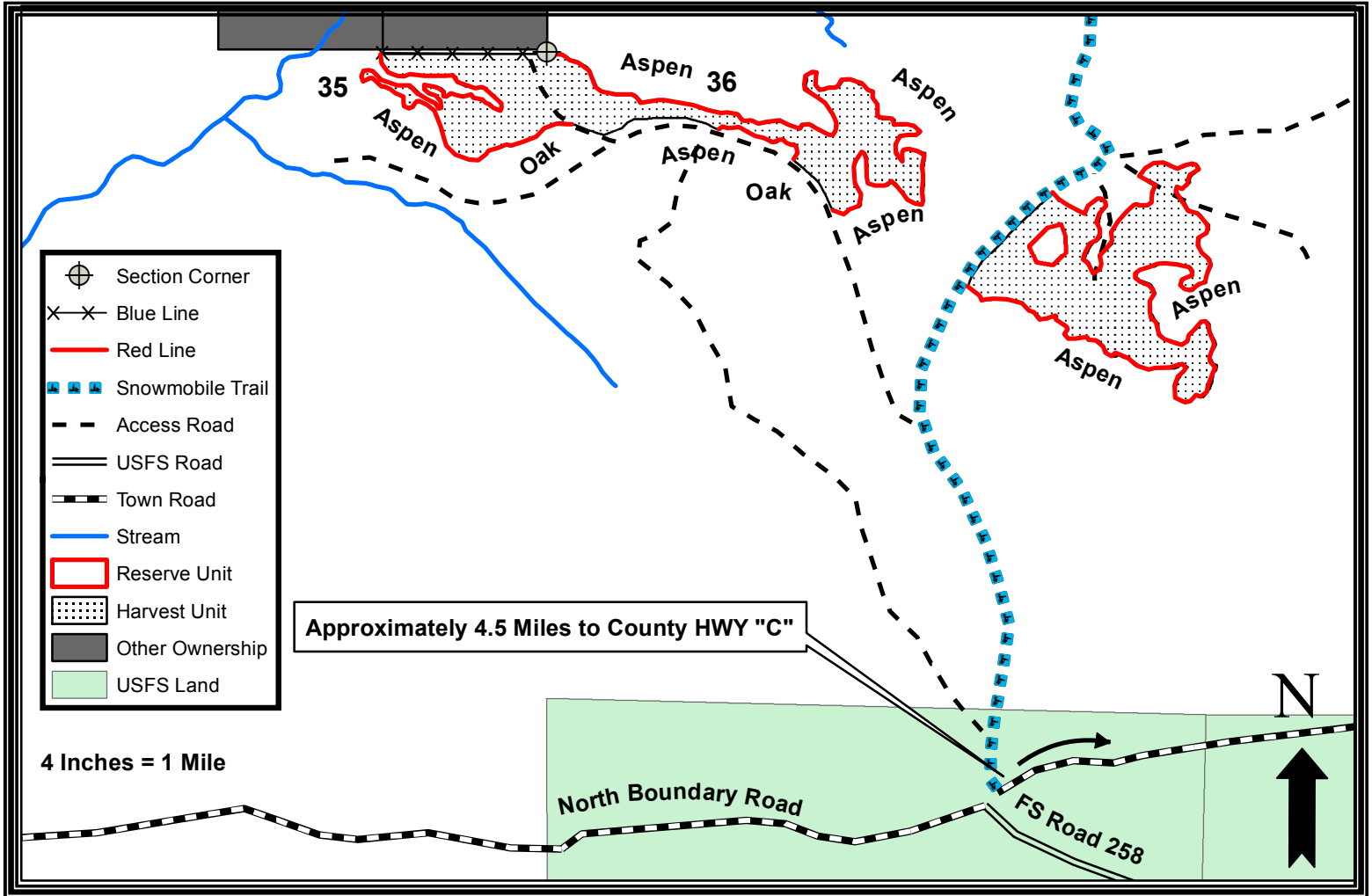

## Harvest requirements:

- This timber sale is being sold on a ticket scale basis.
- Leave all purple marked trees, and leave all conifers except balsam fir.
- Harvest all other trees greater than 4" d.b.h. and sever all stems 2" diameter and larger, EXCEPT for unmapped pockets of red oak saplings and scattered snags throughout the timber sale.
- Harvesting allowed during dry or frozen season only, as determined by the sale administrator.
- To comply with the Best Management Practices for Invasive Species, prior to moving equipment on to or off the sale area, scrape or brush debris and soil from exterior surfaces to the greatest extent possible.
- The existing access roads are open to highway vehicle use in the summer and one segment is a designated snowmobile trail in the winter time. Upon completion of the timber sale these roads will be left open and in good condition, unless otherwise directed by the sale administrator.
- This contract requires County authorization for all road/landing construction and places a number of other requirements on road construction and closure.
- During winter time harvesting, the snowmobile trail must be kept unobstructed, and in a packed snow condition. The purchaser must ensure that harvesting and hauling operations will not create a safety hazard to snowmobiles.
- Sale boundaries are marked with Red Paint or natural type change.
- The property boundary is marked with Blue Paint. (The property line depicted on this map does not constitute a survey). No equipment or felled trees may cross the blue paint line.