

Bayfield County Forestry & Parks Department

Forester: Neitzel			Compartment: 115	Stand: 19	Tract Number: 51-21
Twp: 47N	Range: 9W	Sec: 20	Township: Hughes	Contract Number:	
Topography: Gentle Rolling			Reforestation Code: N/A	Soil: Loamy Sand and Sandy Loam	Acres: 3

Estimated Volumes			
Species	Whole Tree (Tons)	4" Roundwood (Tons)	Sawlogs (MBF)
Aspen*	399		

*Approx. 89% aspen, 4% maple, 3% white birch, 2% red oak, 1% red pine and 1% other species

Special Restrictions:
 >Sale must be whole tree harvested.
 >Sale will have a one year contract

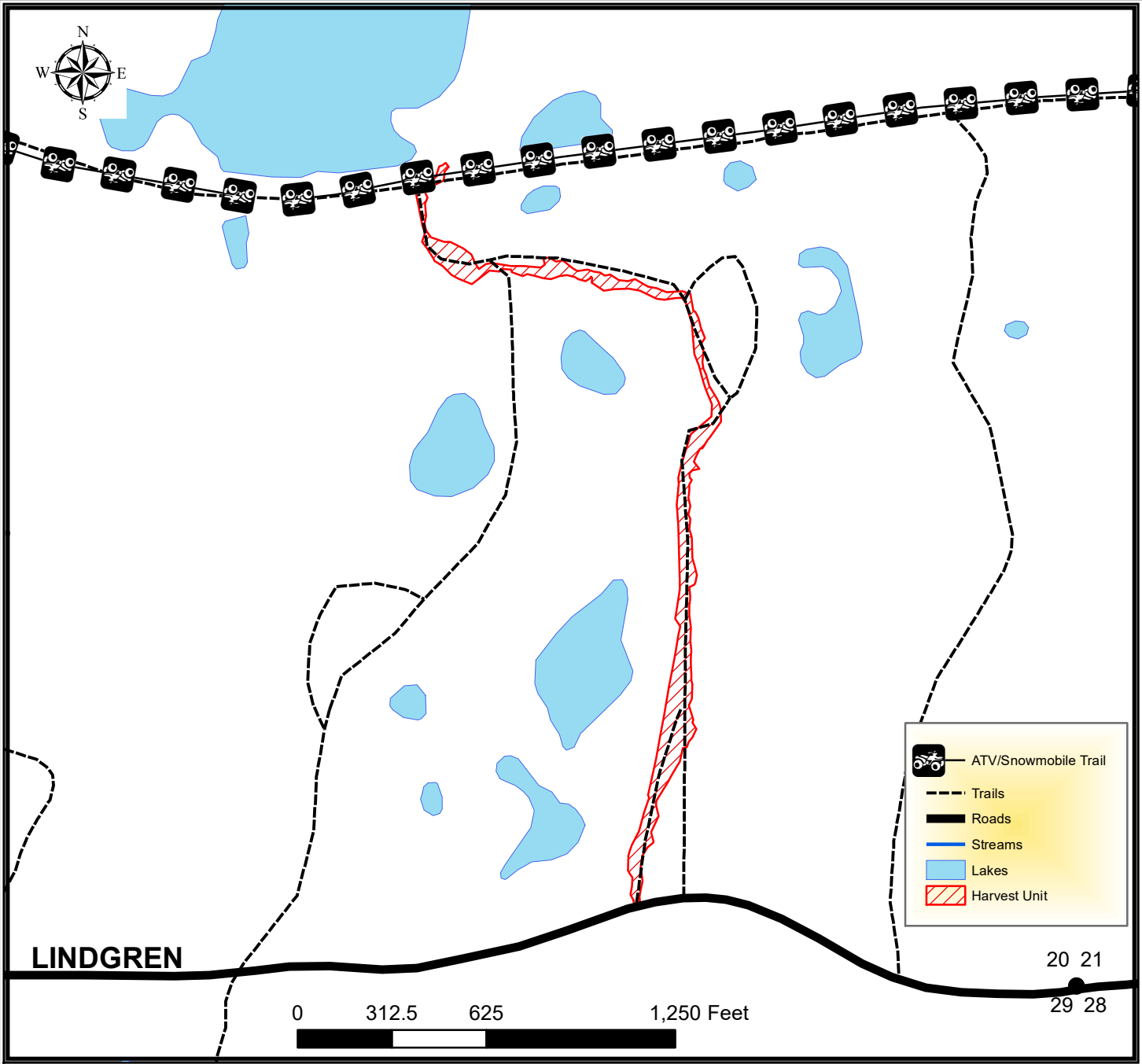

TRACT 51-21 – HARVEST REQUIREMENTS

The following terms and conditions supplement those provided in the Bayfield County Timber Sale Contract.

A. PRESCRIPTION:

1. Harvest unit has a clearcut prescription with an estimated average residual basal area of 0 ft².

B. HARVEST REQUIREMENTS:

1. In harvest unit, harvest all stems marked with yellow or green paint.

C. OPERATIONAL REQUIREMENTS AND SEASONAL RESTRICTIONS:

1. Contractor must harvest all stems and tops.

D. ACCESS AND ROADS:

1. This contract requires County authorization for all road/landing construction and places a number of other requirements on road construction and closure.
2. Decking of wood along town roads will not be allowed without permission from Bayfield County.

E. OTHER:

1. To comply with Best Management Practices for Invasive Species: Prior to moving equipment onto or off the sale area, scrape or brush soil and debris from exterior surfaces to the extent practical.
2. This sale will be sold on a one-year contract.

