

Bayfield County Forestry & Parks Department

Forester: Caleb E. Brown			Compartment: 181 & 186	Stand: 15, 26, 30 & 31; 14	Tract Number: 02-22
Twp: T43N	Range: R9W	Sec: 10, 15, & 16	Township: Barnes	Contract Number:	
Topography: Gently Sloping & Moderate Slopes			Reforestation Code: NA	Soil: Silt Loam, Sandy Loam, & Muck Peat	Acres: 141

Estimated Volumes			
Species	Whole Tree (Tons)	4" Roundwood (Tons)	Sawlogs (MBF)
Mixed Hardwoods	9173	6397*	169**
Balsam Fir	157	114	-

*Approximately 48% Red Maple, 37% Hard Maple, 9% Ash, 3% Basswood, 3% Yellow Birch, 1% Other Hardwood
 **Approximately 37% Red Maple, 37% Hard Maple, 14% Ash, 8% Basswood, 3% Yellow Birch, 1% Other Hardwood

Other
 -Unit 1, 2, and 4 Dry or Frozen Operations Only
 -Unit 4 Frozen Operations Only
 -3 Year Contract

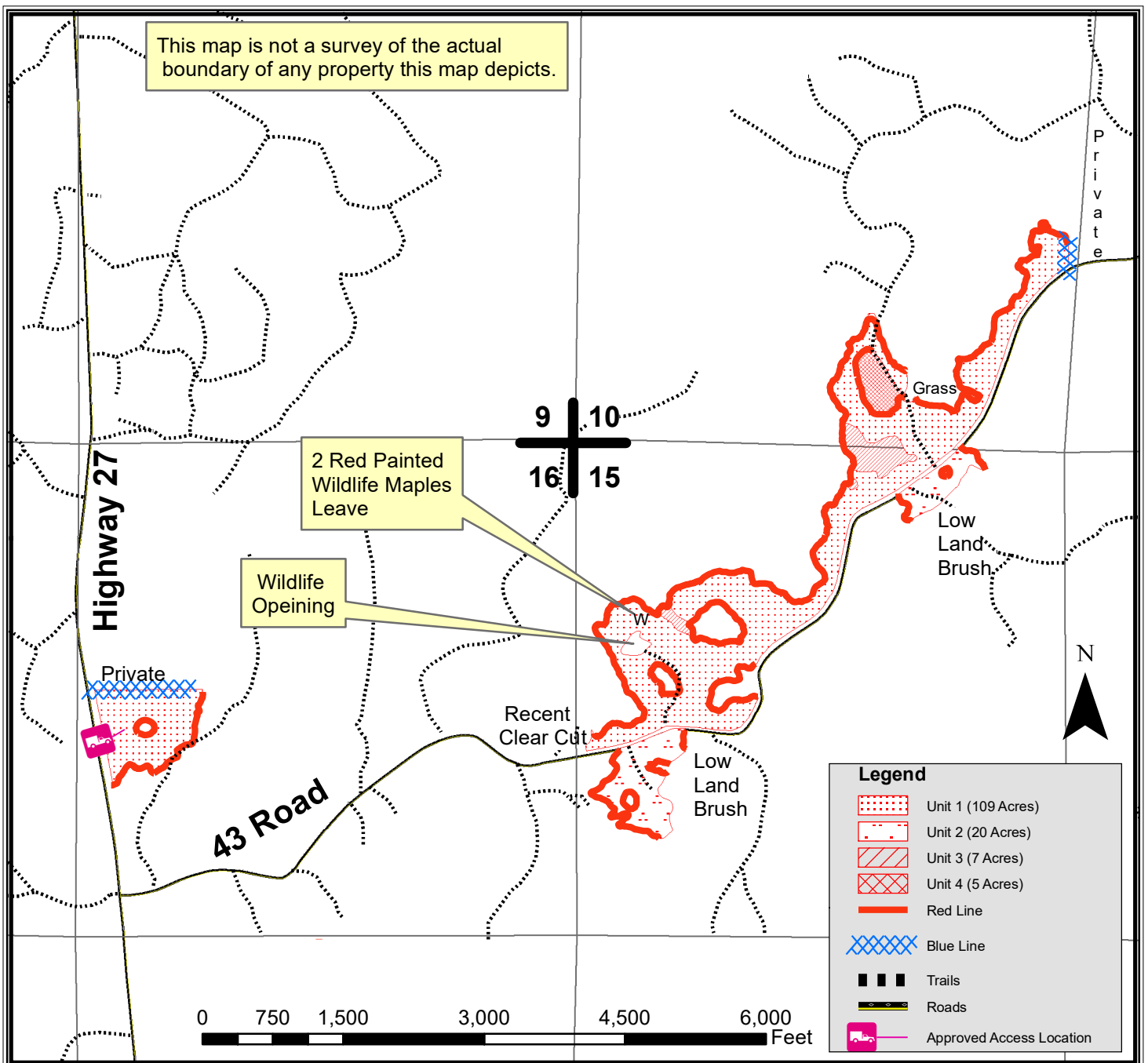

TRACT 02-22 – SUPPLEMENTAL REQUIREMENTS

The following terms and conditions supplement those provided in the Bayfield County Timber Sale Contract.

A. PRESCRIPTION:

1. Unit 1 has a northern hardwood clear-cut with reserves prescription with an estimated average residual basal area of 14 sq ft. (109 acres).
2. Unit 2 has a red maple clear-cut with reserves prescription with an estimated average residual basal area of 13 sq ft (20 acres).
3. Unit 3 has a swamp hardwood clear-cut with reserves prescription with an estimated average residual basal area of 10 sq ft (7 acres).
4. Unit 4 has a northern hardwood thinning prescription with an estimated average residual basal area of 85 sq ft (5 acres).

B. HARVEST REQUIREMENTS:

1. Unit 1, harvest all stems 2 inches and greater except leave all oak, aspen, elm, and non-balsam conifer along with hard maple 4 inches and less, white/yellow birch and fir less than 8 inches.
2. Unit 2, harvest all stems 2 inches and greater except leave all oak, aspen, elm, and conifer along with white/yellow birch 8 inches and less.
3. Unit 3, harvest all stems 2 inches and greater except leave all conifer along with all hard maple and white/yellow birch 8 inches and less.
4. Unit 4, harvest all purple painted stems.

C. HARVEST AND OPERATIONAL REQUIREMENTS AND SEASONAL RESTRICTIONS:

1. Dry or frozen harvest operations only units 1, 2, and 4 (as determined by the county).
2. Frozen ground operations only unit 3.
3. No sale operation allowed between breakup and July 15th in unit 4 (thinning unit).
4. Three-year contract.
5. Utilization specification is to a 4" top. However, if the County determines that pulpwood markets continue to be very poor at the time of harvest the County will sign a contract amendment with the purchaser changing the utilization specification to a 5" top for the selected species. When determining condition of the market, the County will pay particular attention to the amount of wood being purchased by the mills in Wisconsin Rapids and any other significant shifts in the wood demand.
6. The areas that make up unit 3 contain no red line to delineate them from the adjacent units. They are differentiated by an abrupt transition into black ash and elevation changes.
7. In the western portion of the 43 Road portion of Unit 1 leave 2 large diameter red painted maple. They have been designated as wildlife trees (see map).
8. Sale boundaries include red and blue paint line along with abrupt transitions into low land brush, grass, and recent (<5 years) clear cuts.
9. Do not deck wood or disturb soil in wildlife openings, as indicated on map.
10. If harvest will utilize the whole tree, 1 in 10 tops must be left scattered throughout the sale.
11. Do not damage any survey monumentation.

D. ACCESS AND ROADS:

1. County will acquire DOT permit to access the western portion of unit 1 from highway 27. No culvert will be required. Contractor will be responsible for grading approach and complying with other potential DOT permit specifications. Contractor to restore access to original condition post use. DOT will provide requirements to county by mid-April. Information will be available from the county to potential purchaser upon request.
2. Access location will be designated with some combination of wood lath, paint, and flagging.
3. This contract requires County authorization for all road/landing construction and places a number other requirements on road construction and closure.
4. Decking of wood along town roads will not be allowed without permission from Bayfield County.

E. OTHER:

1. To comply with Best Management Practices for Invasive Species: Prior to moving equipment onto or off the sale area, scrape or brush soil and debris from exterior surfaces to the extent practical.

