

Bayfield County Forestry & Parks Department

Forester: Neitzel			Compartment: 116	Stand: 13	Tract Number: 52-21
Twp: 47N	Range: 9W	Sec: 21 and 22	Township: Hughes	Contract Number:	
Topography: Gentle Rolling			Reforestation Code: N/A	Soil: Sand	Acres: 30

Estimated Volumes				*11 inch average diameter
Species	Whole Tree (Tons)	4" Roundwood (Tons)	Sawlogs (MBF)	
Red Pine*	1187	898		

Special Restrictions:
>Harvested pine must be hauled within 3 weeks between May 1st and August 31st.

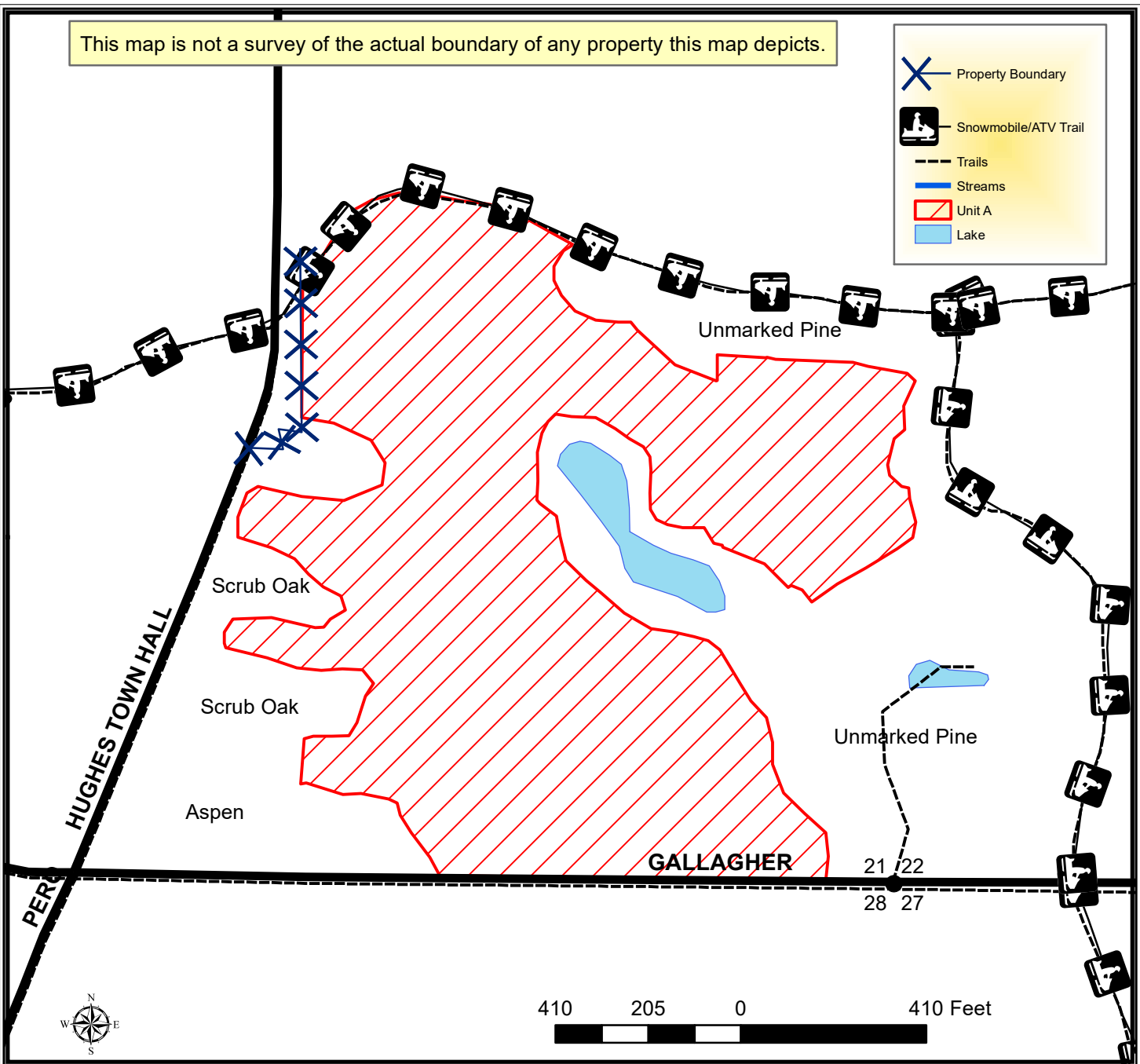

TRACT 52-21 – HARVEST REQUIREMENTS

The following terms and conditions supplement those provided in the Bayfield County Timber Sale Contract.

A. PRESCRIPTION:

1. Harvest unit has a thinning prescription with an estimated average residual basal area of 114 ft².

B. HARVEST REQUIREMENTS:

1. Harvest all orange marked trees.

C. OPERATIONAL REQUIREMENTS AND SEASONAL RESTRICTIONS:

1. Sale boundaries consist of blue paint line, roads, trails and abrupt timber type changes to scrub oak, aspen, marsh or unmarked red pine.
2. The blue line indicates private property. No equipment or felled trees may cross the line.
3. Do not cut snags except for individuals that pose a safety hazard.
4. If harvest will utilize the whole tree, 1 in 10 tops must be left scattered throughout the sale.
5. Harvested pine cannot be kept on the Bayfield County Forest for more than three weeks from May 1st to August 31st.

D. ACCESS AND ROADS:

1. A snowmobile/ATV trail runs along the northern boundary of the sale area, as designated on the map. No logging activity will be allowed on the trail. Signage must be used on the trail when logging activities are taking place adjacent to the trail.
2. This contract requires County authorization for all road/landing construction and places a number of other requirements on road construction and closure.
3. Decking of wood along town roads will not be allowed without permission from Bayfield County.

E. OTHER:

1. To comply with Best Management Practices for Invasive Species: Prior to moving equipment onto or off the sale area, scrape or brush soil and debris from exterior surfaces to the extent practical.
2. Utilization specification is to a 4" top. However, if the County determines that pulpwood markets continue to be very poor at the time of harvest the County will sign a contract amendment with the purchaser changing the utilization specification to a 5" top for selected species. When determining condition of the market, the County will pay particular attention to the amount of wood being purchased by the mills in Wisconsin Rapids and any other significant shifts in wood demand.

