

Bayfield County Forestry & Parks Department

Forester: Mike Amman			Compartment: 7	Stand: 1	Tract Number: 04-23
Twp: N51	Range: 4W	Sec: 15,22	Township: Russell	Contract Number:	
Topography: Flat, rolling			Reforestation Code: natural	Soil: Loamy sand, sand	Acres: 74 14 acres of actual harvest

Estimated Volumes			
Species	Whole Tree (Tons)	4" Roundwood (Tons)	Sawlogs (MBF)
Mixed Hardwood*	896	696	
Red Oak	806	621	
Red Oak			40
Basswood**			10

*Approx. 56% red maple, 17% basswood, 15% sugar maple, 6% yellow birch, 4% ash, 2% aspen
 **Approx. 60% basswood, 40% maple

Special Restrictions:
 No sale operations between breakup and July 15

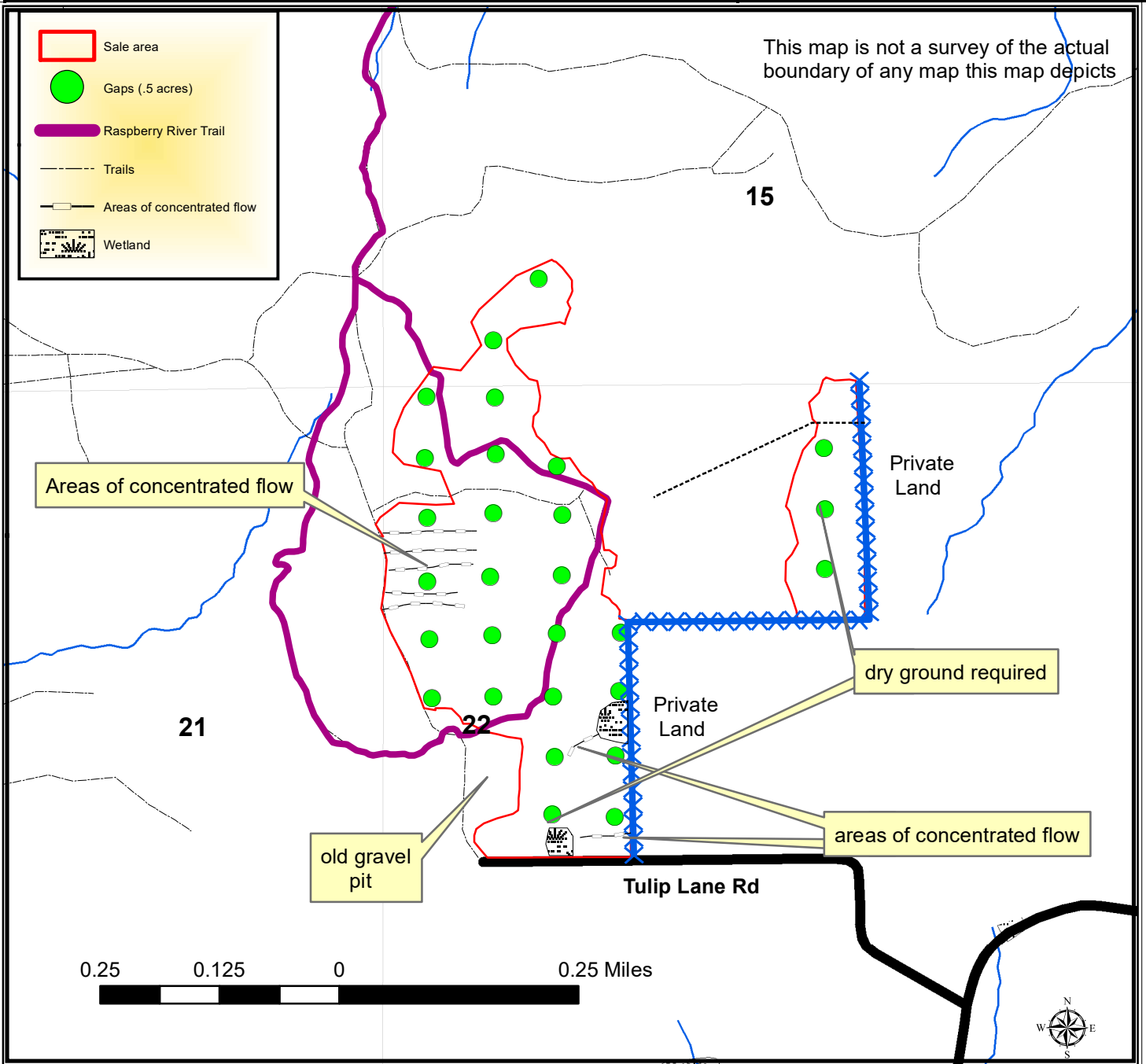

TRACT 4-23 – HARVEST REQUIREMENTS

The following terms and conditions supplement those provided in the Bayfield County Timber Sale Contract.

A. PRESCRIPTION:

- Harvest unit: 1/2 acre patch clearcuts is the harvest prescription with an estimated average residual basal area of 0 sq. ft.

B. HARVEST REQUIREMENTS:

- Harvest unit 1: harvest all hardwood 1" and greater except leave all conifer within the purple painted gaps.
- 28 Gaps are located 330 ft apart from gap center to gap center. No trees were marked in between the gaps. Harvesting of some operational trees to connect to the gaps with the logging equipment will be allowed. Operational trees, if needed, should be the smallest diameter trees possible to gain access to the gaps.
- No sale operations allowed between breakup and July 15th to prevent bark peeling.
- The sale administrator must approve the manner and location of any crossing of these areas of concentrated flow.
- There are two gaps that are on wetter soils that need to be harvested during dry ground conditions.
- If harvest will utilize the whole tree, 1 in 10 tops must be left scattered throughout the sale.

C. ACCESS AND ROADS:

- Access is off Tulip lane. There is an old gravel pit/open area at the end of Tulip lane which is a good spot for a timber landing.

D. OTHER:

- The blue line indicates private property. No equipment or felled trees may cross the blue paint line.
- The raspberry river trail runs through this sale and intersects with a few harvest gaps. Leave the blue painted trees that mark the trail. Keep slash and logging debris off the trail. Minimize damage to the trail tread itself. Contractor needs to give the County 15 days notice before harvesting do give the County time to flag the sections of trail where the gaps interface with the trail.
- In 2018, oak wilt was officially confirmed in Bayfield County. Currently, this timber sale is located more than six miles away from the closest known infected tree. However, over the duration of this contract, additional infections could be discovered. If, over the duration of this contract, including extensions, oak wilt is officially confirmed within a six mile radius of this timber sale, as determined by the county, the following seasonal restriction will be applied: no harvesting operations will be allowed between April 15 (or as otherwise determined by the county) and July 15
- To comply with Best Management Practices for Invasive Species: Prior to moving equipment onto or off the sale area, scrape or brush soil and debris from exterior surfaces to the extent practical.
- Do not damage any survey monumentation.