

Bayfield County Forestry & Parks Department

Forester: Andrew O'Krueg			Compartment: 144	Stand: 8	Tract Number: 01-23
Twp: 46N	Range: 9W	Sec: 26	Township: Barnes	Contract Number:	
Topography: Gently Rolling			Reforestation Code: Seed to PJ	Soil: Loamy Sand	Acres: 38

Estimated Volumes				*Avg. diameter = 10.3 inches
Species	Whole Tree (Tons)	4" Roundwood (Tons)	Sawlogs (MBF)	* Approx. 99% Red Pine and 1% Other
Red Pine*	3961	2961		Special Restrictions: >Harvested pine must be hauled within 3 weeks between May 1st and August 31st.

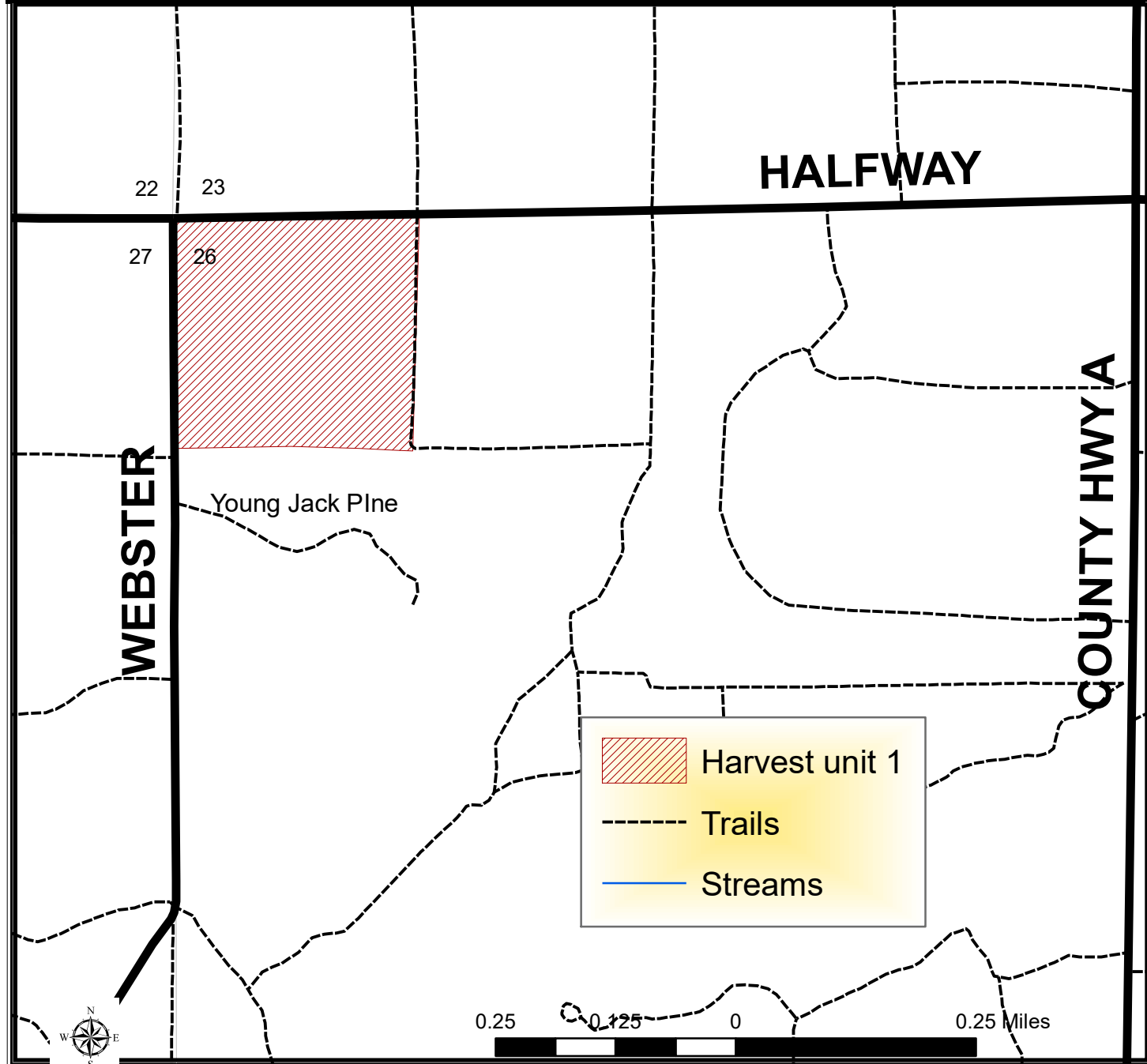

TRACT 01-23 – HARVEST REQUIREMENTS

The following terms and conditions supplement those provided in the Bayfield County Timber Sale Contract.

A. PRESCRIPTION:

1. Harvest unit 1 has a clearcut prescription with an estimated average residual basal area of 0 ft².

B. HARVEST REQUIREMENTS:

1. Harvest all trees 2" in diameter and greater within the sale area.

C. OPERATIONAL REQUIREMENTS AND SEASONAL RESTRICTIONS:

1. Sale boundaries consist of Halfway road on the north, Webster road on the west, a forest road on the east, and a young pine plantation to the south.
2. Fell all standing non-merchantable dead and dying stems. Process all felled stems into standard 100-inch lengths and scatter. Process all greater than 8-inch DBH non-merchantable downed stems into standard 100-inch lengths and scatter.
3. Conduct harvest so that the slash, limbs, and tops from every two passes are piled by the processor in a single common windrow that can be burned by the County after the sale. Do not operate equipment on this windrow. See contract administrator for further information.
4. Harvested pine cannot be kept on the Bayfield County Forest for more than three weeks from May 1st to August 31st.
5. Cut all snags.
6. If harvest will utilize the whole tree, 1 in 10 tops must be left scattered throughout the sale.

D. ACCESS AND ROADS:

1. This contract requires County authorization for all road/landing construction and places a number of other requirements on road construction and closure.
2. Decking of wood along town roads will not be allowed without permission from Bayfield County.

E. OTHER:

1. To comply with Best Management Practices for Invasive Species: Prior to moving equipment onto or off the sale area, scrape or brush soil and debris from exterior surfaces to the extent practical.
2. Do not damage any survey monumentation.

