

# Bayfield County Forestry and Parks Department

Forester: Coonen			Compartment: 109	Stand: 1, 30	Tract Number: 43-23 Acres: 63
Twp: 47N	Range: 9W	Sec: 12	Township: Hughes	Contract Number:	
Topography: Rolling Hills			Reforestation Code: None	Soil: Sand	

Estimated Volumes				* Average diameter of 13"
Species	Whole Tree (Tons)	4" Roundwood (Tons)	Sawlogs (MBF)	**Contains 99% red pine and 1% misc.
Red Pine*	3346	2655**		

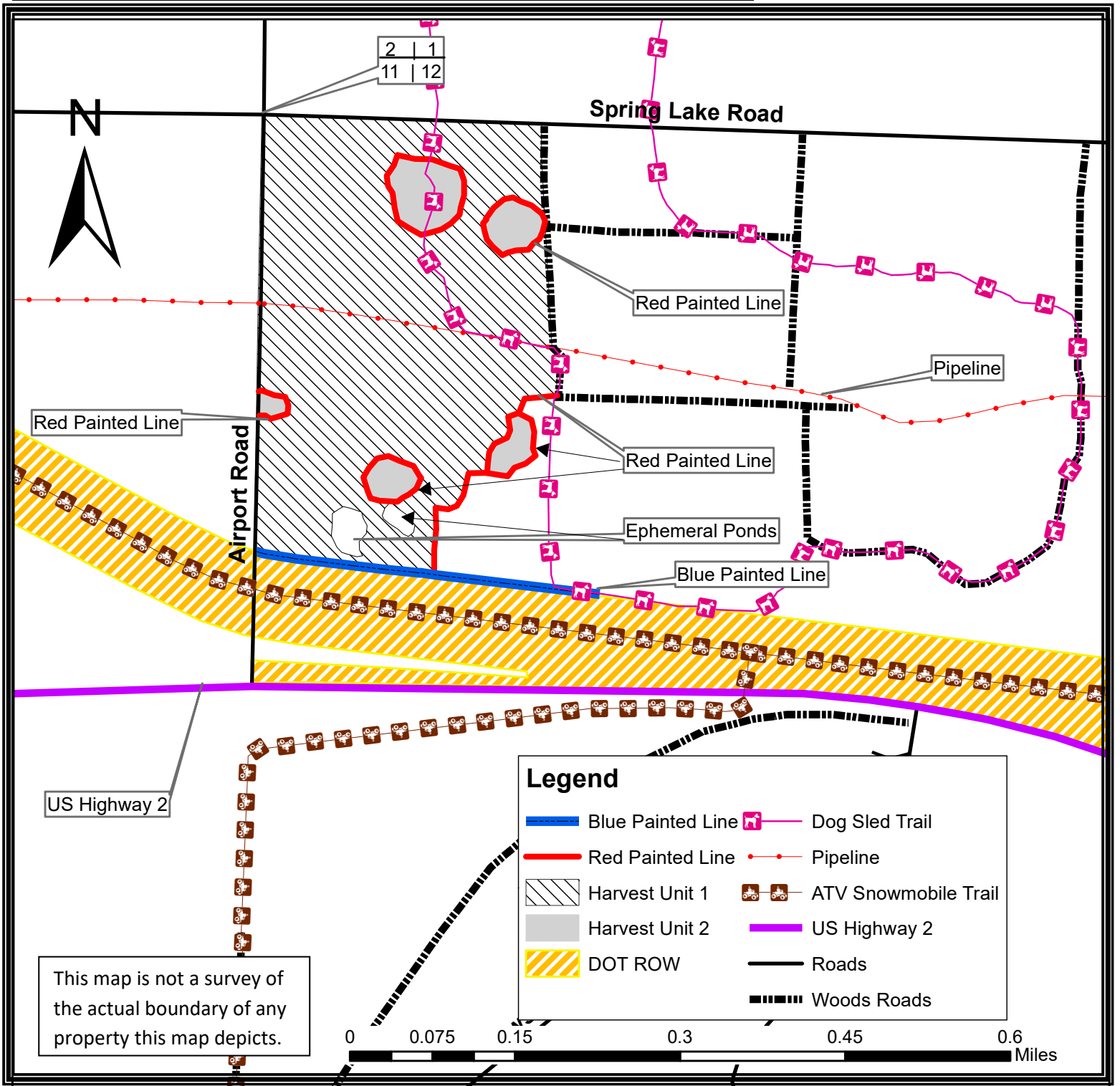

## TRACT 43-23 – SUPPLEMENTAL REQUIREMENTS

The following terms and conditions supplement those provided in the Bayfield County Timber Sale Contract.

### A. PRESCRIPTION:

- Harvest Unit 1: has a thinning prescription with an estimated average residual basal area of 103 ft<sup>2</sup>/acre.
- Harvest Unit 2: has a clearcut prescription with an estimated average residual basal area of 0 ft<sup>2</sup>/acre.

### B. HARVEST REQUIREMENTS:

- Harvest Unit 1: Harvest all orange marked trees.
- Harvest Unit 1: Leave and avoid damage to all unmarked trees.
- Harvest Unit 2: Harvest all stems 4" or greater.

### C. OPERATIONAL REQUIREMENTS AND SEASONAL RESTRICTIONS:

- Sale boundaries consist of Spring Lake Road, Airport Road, blue paint, red paint, and woods trails.
- If harvest will utilize the whole tree, 1 in 10 tops must be left scattered throughout the sale.
- Harvested pine cannot be kept on the Bayfield County Forest for more than three weeks from May 1<sup>st</sup> to August 31<sup>st</sup>.
- Do not cut snags except for individuals that pose a safety hazard.
- There are two ephemeral ponds marked on the map, there will be no decking of wood or equipment operation within these open areas.
- Utilization specification is to a 4" top. However, if the County determines that pulpwood markets continue to be very poor at the time of harvest the County will sign a contract amendment with the purchaser changing the utilization specification to a 5" top for selected species. When determining condition of the market, the County will pay particular attention to the amount of wood being purchased by the mills in Wisconsin Rapids and any other significant shifts in wood demand.

### D. ACCESS AND ROADS:

- This contract requires County authorization for all road/landing construction and places a number of other requirements on road construction and closure.
- Decking of wood along town roads will not be allowed without permission from Bayfield County.
- The Tri-County Corridor runs along the south end of the sale. No equipment or decking of wood will be allowed on the corridor. Caution must be taken and appropriate signage used.
- The access road crosses a Natural Gas pipeline as noted on the map. Digger's hotline must mark the line and the pipeline company must be contacted prior to crossing. The pipeline company may place conditions on crossing the line. In the past they have requested that soil lift be used where the road crosses the line. Timber mats are another possible solution for crossing the pipeline.
- There is a dog sled trail that runs through the harvest areas. Keep slash and logging debris off the trail. Minimize damage to the trail tread itself. Contractor needs to give the County 15 days notice before harvesting do give the County time to flag the sections of trail where the sale interfaces with the trail.

### E. OTHER:

- To comply with Best Management Practices for Invasive Species: Prior to moving equipment onto or off the sale area, scrape or brush soil and debris from exterior surfaces to the extent practical.
- Do not damage any survey monumentation.