

# Bayfield County Forestry and Parks Department

Forester: LeBouton		Compartment: 128		Stand: 8, 14		Tract Number: 28-23
Twp: 46N	Range: 9W	Sec: 4	Township: Hughes	Contract Number:		
Topography: flat		Reforestation Code: Thinning		Soil: Sandy		Acres: 127

Estimated Volumes				*14" Average diameter
Species	Whole Tree (Tons)	4" Roundwood (Tons)	MBF	
Red pine*	6015	4620	XX	
				Harvested pine may not be kept on the Bayfield County Forest for more than three weeks from May 1st to August 31st.

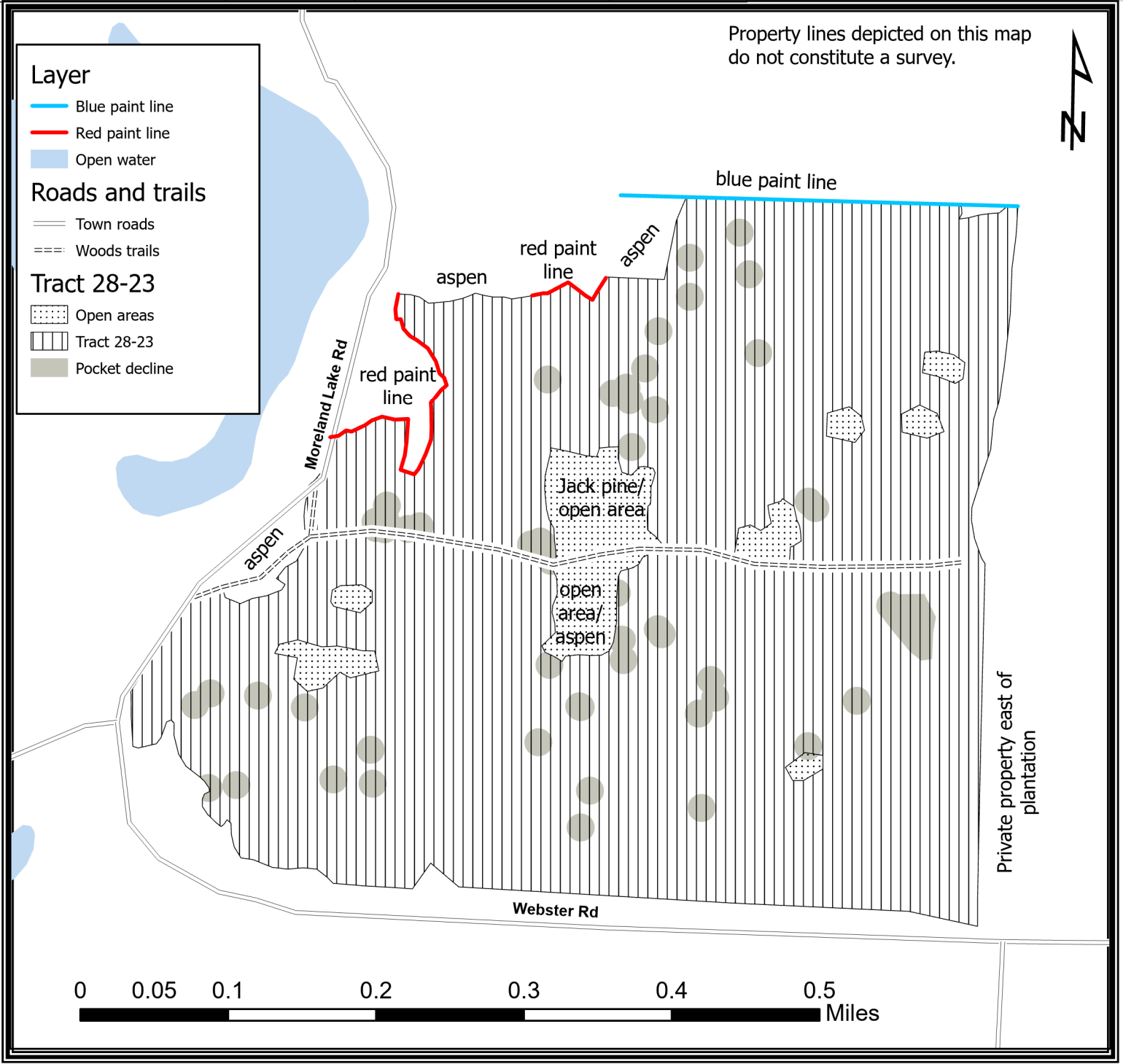

## TRACT 28-23 – HARVEST REQUIREMENTS

The following terms and conditions supplement those provided in the Bayfield County Timber Sale Contract.

### A. PRESCRIPTION:

1. Marked fourth thinning in red pine. Residual basal area of 111 sq.ft./acre.
2. In areas with evidence of red pine pocket decline, trees within 45 feet of infected or dead red pine individuals are marked for harvest. Total area of all pockets combined is approximately 8.5 acres.

### B. HARVEST REQUIREMENTS

1. HARVEST all orange-marked red pine and all dead red pine. Do not harvest or damage unmarked trees.
2. In areas of red pine pocket decline, all trees are marked with orange paint for removal within approximately 45 feet of infected trees. Approximate locations of most pockets are shown on the map. A small number of additional unmapped pockets exist on the east side of the stand. All trees to be harvested are marked with orange paint.

### C. OPERATIONAL REQUIREMENTS and SEASONAL RESTRICTIONS:

1. No seasonal restrictions.
2. Harvested pine may not be kept on the Bayfield County Forest for more than three weeks from May 1<sup>st</sup> to August 31<sup>st</sup>.
3. Sale boundaries are red paint lines, town roads, and cover type changes, as shown on map.
4. If harvest will utilize the whole tree, 1 in 10 tops must be left scattered throughout the sale.

### D. ACCESS AND ROADS:

1. This contract requires County authorization for all road/landing construction and places a number of other requirements on road construction and closure.
2. Decking of wood along town roads will not be allowed without permission from Bayfield County.

### E. OTHER:

1. Utilization specification is to a 4" top. However, if the County determines that pulpwood markets continue to be very poor at the time of harvest the County will sign a contract amendment with the purchaser changing the utilization specification to a 5" top for selected species. When determining condition of the market, the County will pay particular attention to the amount of wood being purchased by the mills in Wisconsin Rapids and any other significant shifts in wood demand
2. To comply with Best Management Practices for Invasive Species: Prior to moving equipment onto or off the sale area, scrape or brush soil and debris from exterior surfaces to the extent practical.
3. Do not damage survey monumentation.

