

# Bayfield County Forestry and Parks Department

Forester: LeBouton		Compartment: 14		Stand: 6	Tract Number: 29-23
Twp: 51N	Range: 5W	Sec: 24	Township: Bayfield	Contract Number:	
Topography: Rolling		Reforestation Code: Site prep and plant		Soil: Sandy	Acres: 24

  

Estimated Volumes			
Species	Whole Tree (Tons)	4" Roundwood (Tons)	MBF
Red pine	3640	2770*	XX

\*15" Average diameter, includes less than 1% mixed aspen, ash, red maple, and misc. species.

DRY OR FROZEN season only.  
No harvesting between March 20<sup>th</sup> and June 20<sup>th</sup>.

Harvested pine may not be kept on the Bayfield County Forest for more than three weeks from May 1<sup>st</sup> to August 31<sup>st</sup>.

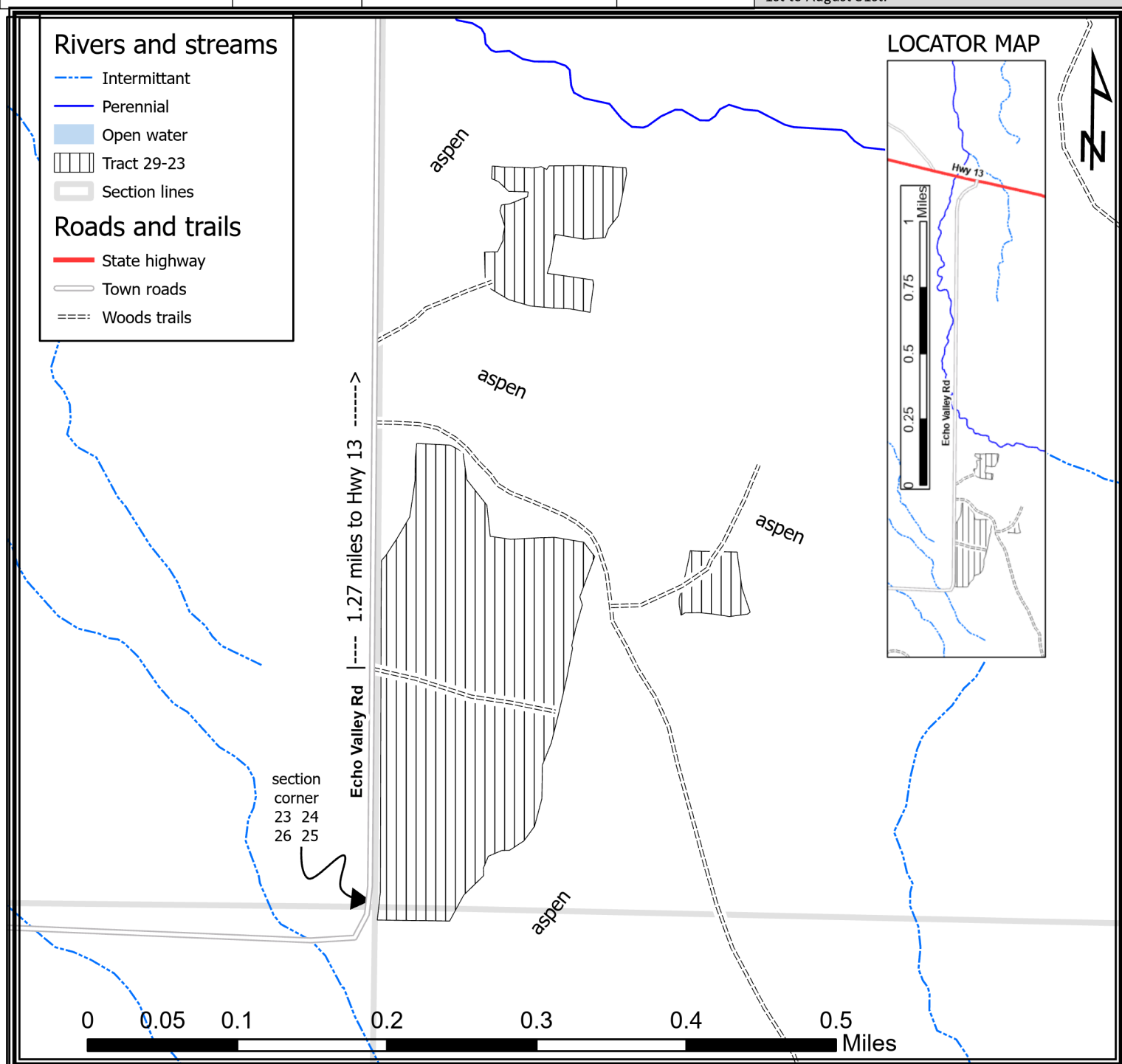

## TRACT 29-23 – HARVEST REQUIREMENTS

The following terms and conditions supplement those provided in the Bayfield County Timber Sale Contract.

### A. PRESCRIPTION:

1. Regeneration harvest in a red pine plantation . Remove all trees in preparation for replanting to red pine.

### B. HARVEST REQUIREMENTS

1. HARVEST all red pine and all other stems 1 inch dbh and greater within the red pine plantation.

### C. OPERATIONAL REQUIREMENTS and SEASONAL RESTRICTIONS:

1. Due to sand-mantled clay soils, harvest in dry or frozen season as determined by timber sale administrator .
2. Due to an NHI hit, no harvesting allowed between March 20<sup>th</sup> and June 20<sup>th</sup>.
3. Fell all standing non-merchantable dead and dying stems. Process all felled stems into standard 100 -inch lengths and scatter. Process all greater than 8-inch DBH non-merchantable downed stems into standard 100-inch lengths and scatter.
4. Conduct harvest so that the slash, limbs, and tops from every two passes are piled by the processor in a single common windrow that can be burned by the County after the sale. Do not operate equipment on this windrow. See contract administrator for further information.
5. Harvested pine may not be kept on the Bayfield County Forest for more than three weeks from May 1<sup>st</sup> to August 31<sup>st</sup>.
6. Sale boundaries are cover type changes, as shown on map.
7. If harvest will utilize the whole tree, 1 in 10 tops must be left scattered throughout the sale.

### D. ACCESS AND ROADS:

1. This contract requires County authorization for all road/landing construction and places a number of other requirements on road construction and closure.
2. Decking of wood along town roads will not be allowed without permission from Bayfield County.

### E. OTHER:

1. Utilization specification is to a 4" top.
2. To comply with Best Management Practices for Invasive Species: Prior to moving equipment onto or off the sale area, scrape or brush soil and debris from exterior surfaces to the extent practical.
3. Do not damage survey monumentation.

