

# Bayfield County Forestry and Parks Department

Forester: Haas/Coonen		Compartment: 138		Stand: 2		Tract Number: 32-23
Twp: 46N	Range: 9W	Sec: 14	Township: Hughes		Contract Number:	
Topography: flat		Reforestation Code:		Soil: Sandy		Acres: 31

Estimated Volumes				*Third thin, Average diameter 11"
Species	Whole Tree (Tons)	4" Roundwood (Tons)	MBF	
Red pine*	1050	785	0	
				Harvested pine may not be kept on the Bayfield County Forest for more than three weeks from May 1st to August 31st.

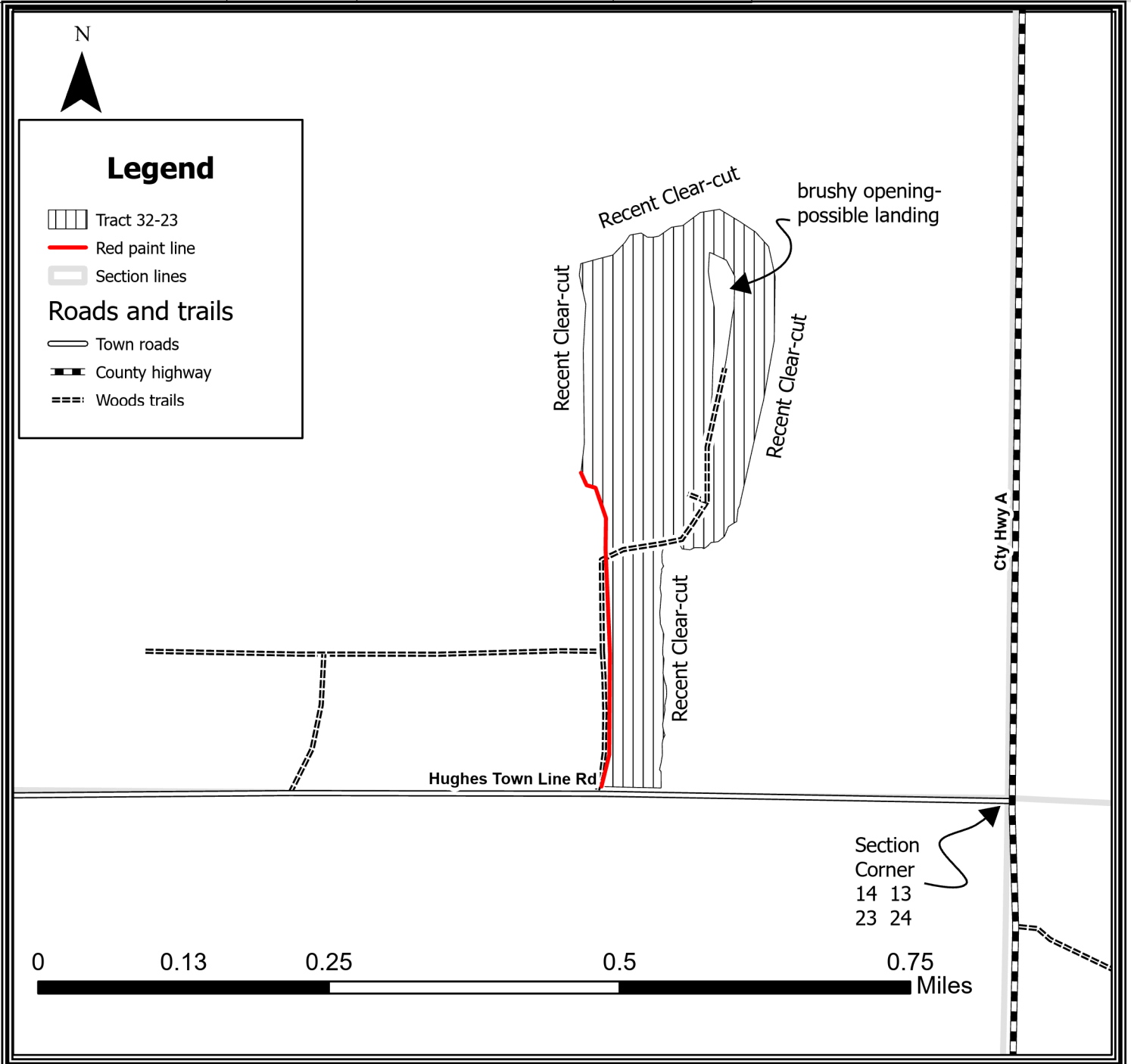

# TRACT 32-23 – HARVEST REQUIREMENTS

The following terms and conditions supplement those provided in the Bayfield County Timber Sale Contract.

## A. PRESCRIPTION:

1. Red pine thinning prescription with an estimated average residual basal area of 100 ft<sup>2</sup>/acre.

## B. HARVEST REQUIREMENTS

1. HARVEST all orange-marked red pine. Do not harvest or damage unmarked trees.
2. Leave all un-painted red pine undamaged.

## C. OPERATIONAL REQUIREMENTS and SEASONAL RESTRICTIONS:

1. No seasonal restrictions.
2. Harvested pine may not be kept on the Bayfield County Forest for more than three weeks from May 1<sup>st</sup> to August 31<sup>st</sup>.
3. Sale boundaries are red paint lines, cover type changes, Hughes Town Line Road, and woods trails, as shown on map.
4. If harvest will utilize the whole tree, 1 in 10 tops must be left scattered throughout the sale.
5. Utilization specification is to a 4" top. However, if the County determines that pulpwood markets continue to be very poor at the time of harvest the County will sign a contract amendment with the purchaser changing the utilization specification to a 5" top for selected species. When determining condition of the market, the County will pay particular attention to the amount of wood being purchased by the mills in Wisconsin Rapids and any other significant shifts in wood demand.

## D. ACCESS AND ROADS:

1. This contract requires County authorization for all road/landing construction and places a number of other requirements on road construction and closure.
2. Decking of wood along town roads will not be allowed without permission from Bayfield County.

## E. OTHER:

1. To comply with Best Management Practices for Invasive Species: Prior to moving equipment onto or off the sale area, scrape or brush soil and debris from exterior surfaces to the extent practical.
2. Do not damage survey monumentation.

