

# Bayfield County Forestry & Parks Department

Forester: Caleb Brown			Compartment: 171	Stand: 1, 2, & 10	<b>Tract Number: 41-23</b>
Twp: T44N	Range: R9W	Sec: 25 & 26	Township: Barnes	Contract Number:	
Topography: Level and Gentle Rolling			Reforestation Code: Natural	Soil: Sandy Loam & Loamy Sand	<b>Acres: 281</b> (227 acres of actual harvest)

Estimated Volumes				*Approximatley 58% hard maple, 26% basswood, 13% ash, 2% red maple, and 1% other and 1% other hardwoods. **Approximatley 60% hard maple, 19% ash, 18% basswood, 2% red maple, and 1% other hardwood
Species	Whole Tree (Tons)	4" Roundwood (Tons)	Sawlogs (MBF)	
Mixed Hardwoods*	16920	13406	-	<b>Other</b> -3 Year Contract -Frozen or Drv -Two Stream Crossings (see suplimental requirements) -Utilization Specification (see supplemental requirements)
Mixed Hardwoods**	-	-	417	

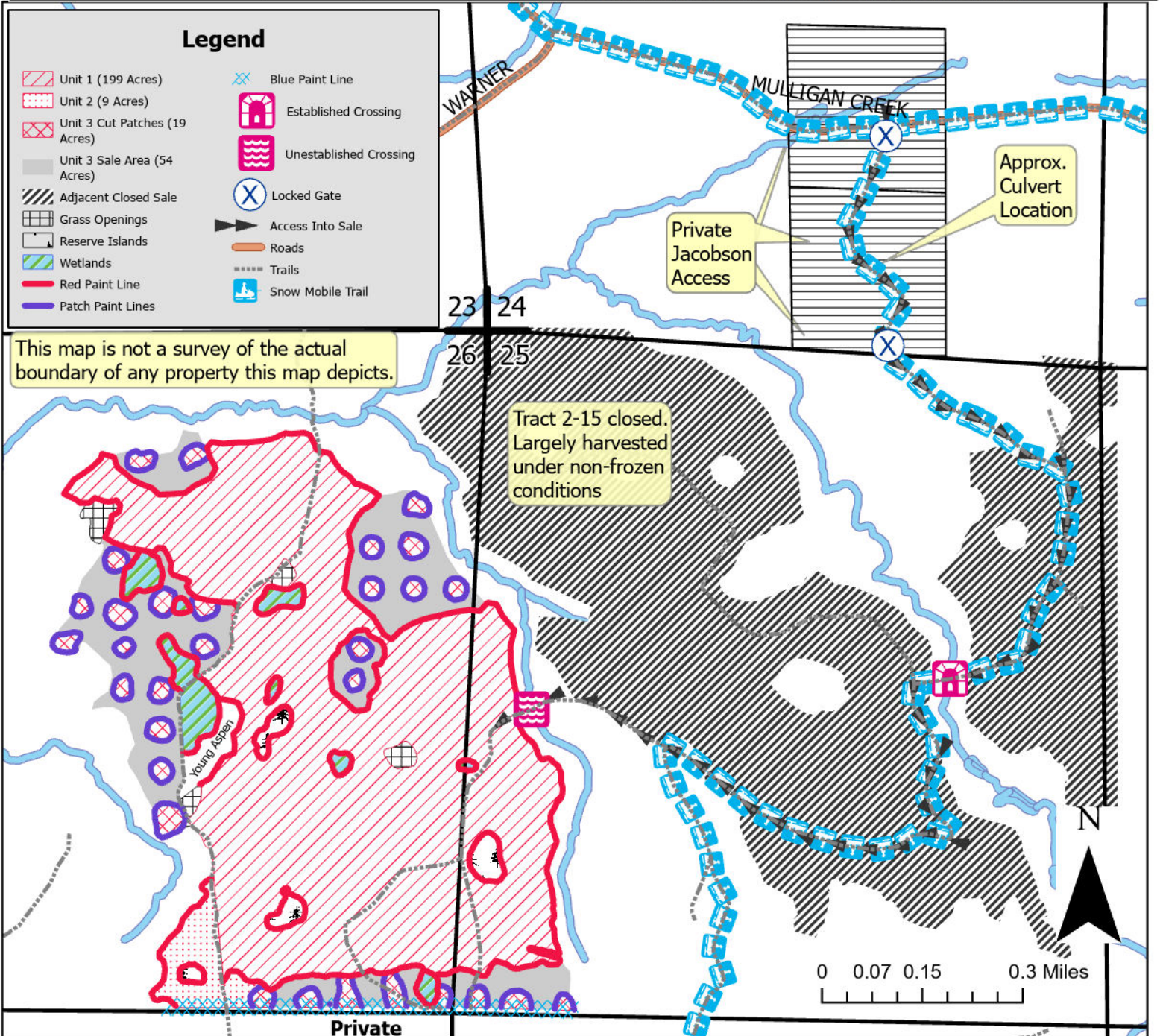

## TRACT 41-23 – SUPPLEMENTAL REQUIREMENTS

The following terms and conditions supplement those provided in the Bayfield County Timber Sale Contract.

### A. PRESCRIPTION:

- Unit 1 has an overstory removal prescription with an estimated average residual basal area of 8 ft<sup>2</sup>.
- Unit 2 has a clear cut with reserves prescription with an estimated average residual basal area of 17 ft<sup>2</sup>.
- Unit 3 has a patch harvest prescription with an estimated average residual basal area of 7 ft<sup>2</sup> inside the patches. There are 31 patches totaling 19 acres.

### B. HARVEST REQUIREMENTS:

- Unit 1, harvest all hardwood stems 8 inches and greater except for oak, elm, birch, and ash spp. Harvest all ash stems 2 inches and greater. Leave all conifer.
- Unit 2, harvest all hardwood stems 2 inches and greater except for oak, elm, birch spp., and purple marked trees. Leave all conifer.
- Unit 3, harvest all hardwood stems 1 inch and greater except for oak, elm, and birch spp. inside patches. Leave all conifer. Patch areas are designated with 2 purple dots facing into the patch and a purple slash on back of the tree. In areas where patches connect with red or blue paint line the blue or red paint line then serve as patch boundaries also. There are 31 patches that average .6 acres in size. Patches are roughly 330 ft from patch center to patch center.

### C. HARVEST AND OPERATIONAL REQUIREMENTS AND SEASONAL RESTRICTIONS:

- Sale operations may only occur when the ground is frozen or exceptionally dry conditions as determined by Bayfield County.
- Sale boundaries include red, blue, and purple paint line.
- There are some scattered smaller (<.1 acre) Ash swales inside unit 1 and 2 that were not redlined around. If the harvest equipment cannot travel through the swale or reach all the trees (including non-ash) in a swale from the edge of the swale because of soft soil conditions, they can be left if these conditions are not available during the sale period. The larger and wetter swales were red lined around and do not need to be harvested.
- Utilization specification is to a 4" top. However, if the County determines that pulpwood markets continue to be very poor at the time of harvest the County will sign a contract amendment with the purchaser changing the utilization specification to a 5" top for the selected species. When determining condition of the market, the County will pay particular attention to the amount of wood being purchased by the mills in Wisconsin Rapids and any other significant shifts in the wood demand.
- If harvest will utilize the whole tree, 1 in 10 tops must be left scattered throughout the sale.
- Leave all snags that do not pose a safety hazard.

### D. ACCESS AND ROADS:

- Access through sale in part runs through private property. Private access road must be returned to similar or better condition upon closeout.
- Access passes through 2 private locked gates that both require the same key. County can provide access though gates upon request. Gate must be closed and locked on days when hauling and harvesting will not take place. There is a 12" culvert on private property that is buried shallow. Culvert needs to remain intact.
- The County has obtained two temporary stream crossing permits for two stream crossings. One for an already established temporary bridge (that is still in place and has been permitted before) over the Ounce River and a new temporary permit on a tributary to the Ounce River.
- The already established stream crossing bridge, due to its age, must be overlaid with crane mats to provide additional reinforcement.
- For the new stream crossing a temporary timber mat bridge crossing will be installed by the contractor according to the permit specifications, in the location indicated by the map. The new crossing must be installed with a machine that can lift the mats completely off the ground and set them over the crossing. Equipment may not cross the drainage until the bridge is constructed. A mat must be used to serve as a sill on each end. The completed bridge must have a minimum of 12 inches of clearance over the stream.
- County may have crane mats available than can be borrowed for these crossings.
- Both bridges must be removed upon completion of the sale. The established crossing bridge and any County timber mats used for either crossing to be returned to a designated storage location which will likely be in Iron River or Washburn. Established crossing bridge cannot be pulled during snowmobile season. Contractor may need to return after the end of winter to remove this bridge.
- Mulligan Creek road functions as a snow mobile route during the winter and the haul route into the sale is also a snow mobile trail (trail #31). During harvest operations the snowmobile trail must be kept unobstructed and in packed snow conditions. Contractor to post appropriate signage on the route/trail and use caution while hauling on these roads/trails.
- Excessive damage (beyond normal wear and tear) to be snowmobile route/trail as determined by the county, will not be tolerated. If Bayfield County determines excessive damage has occurred, the Contractor may be held responsible for a portion or all of the repair. The County and Contractor must communicate on a regular basis to ensure issues are addressed in a timely manner and the snowmobile route/trail remains in a safe and acceptable condition.
- This contract requires County authorization for all road/landing construction and places a number of other requirements on road construction and closure.
- Decking of wood along town roads will not be allowed without permission from Bayfield County.

### E. OTHER:

- To comply with Best Management Practices for Invasive Species: Prior to moving equipment onto or off the sale area, scrape or brush soil and debris from exterior surfaces to the extent practical.
- This sale will be sold as a **three (3) year contract**. Contract extensions are not guaranteed.

