

# Bayfield County Forestry and Parks Department

Forester: LeBouton		Compartment: 68		Stand: 12		Tract Number: 46-23
Twp: 49N	Range: 5W	Sec: 8	Township: Bayview	Contract Number:		
Topography: Flat		Reforestation Code: None: first thin PR		Soil: Sandy		Acres: 24

Estimated Volumes			
Species	Whole Tree (Tons)	4" Roundwood (Tons)	MBF
Red pine*	920	650	xx

\*first thin, 8" average diameter. Includes 15% jack pine.

Harvested pine may not be kept on the Bayfield County Forest for more than three weeks from May 1st to August 31st.

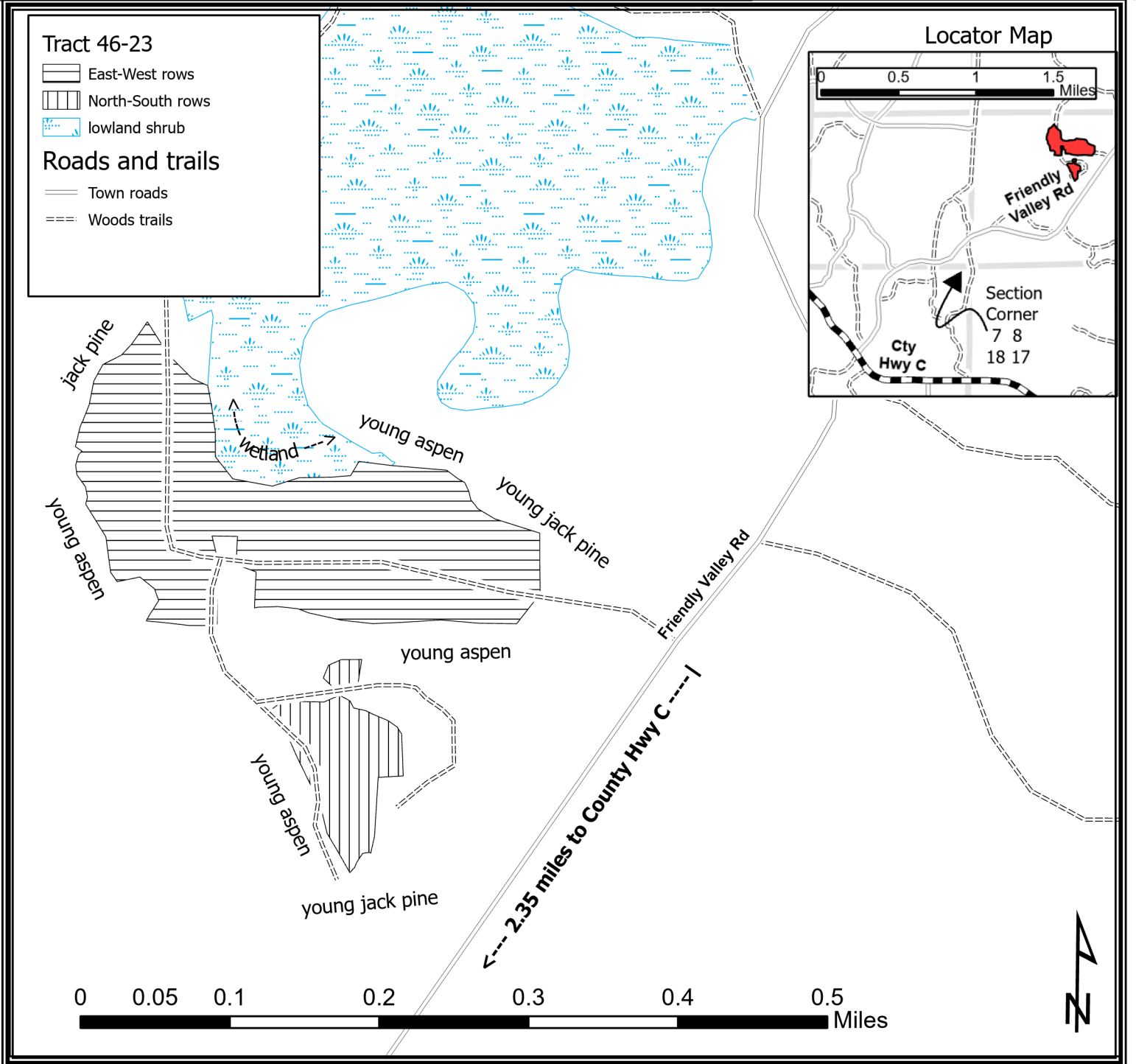

# TRACT 46-23 – HARVEST REQUIREMENTS

The following terms and conditions supplement those provided in the Bayfield County Timber Sale Contract.

## A. PRESCRIPTION:

1. First thin in 39 year old red pine plantation.

## B. HARVEST REQUIREMENTS

1. Cut all trees in every third row (cut one row, leave two rows). Cut rows are not marked with paint. Logger will determine cut rows to the satisfaction of the Sale Administrator.

## C. OPERATIONAL REQUIREMENTS and SEASONAL RESTRICTIONS:

1. No seasonal restrictions.
2. Do not fuel or perform maintenance on machinery within 100ft of mapped wetland.
3. Harvested pine may not be kept on the Bayfield County Forest for more than three weeks from May 1<sup>st</sup> to August 31<sup>st</sup>.
4. Sale boundaries are cover type changes, as shown on map.
5. If harvest will utilize the whole tree, 1 in 10 tops must be left scattered throughout the sale.

## D. ACCESS AND ROADS:

1. This contract requires County authorization for all road/landing construction and places a number of other requirements on road construction and closure.
2. Decking of wood along town roads will not be allowed without permission from Bayfield County.

## E. OTHER:

1. Utilization specification is to a 4" top. However, if the County determines that pulpwood markets continue to be very poor at the time of harvest the County will sign a contract amendment with the purchaser changing the utilization specification to a 5" top for selected species. When determining condition of the market, the County will pay particular attention to the amount of wood being purchased by the mills in Wisconsin Rapids and any other significant shifts in wood demand
2. To comply with Best Management Practices for Invasive Species: Prior to moving equipment onto or off the sale area, scrape or brush soil and debris from exterior surfaces to the extent practical.
3. Do not damage survey monumentation.

